

# Smart home made easy

The intelligent home control system  
for new builds and renovations



**:hager**



	Page
The easy answer	4
Hager makes things easy	6
easy installation	10
easy configuration	16
easy visualisation	20
easy operation	24
Product overview	29
KNX easy operating systems	30
KNX easy sensors	61
KNX easy actuators	71
KNX easy devices	83
KNX radio transmitters	86
KNX radio receivers	87
System components & accessories	88

# the easy answer!

easy from Hager, the new home control system that provides an easy-to-use application in private residential buildings, is the answer that many electrical installers have been waiting for. It's a novel, uncomplicated, quick and inexpensive solution – but above all else, the new easy configuration software is, as its name suggests, a breeze to use. You don't need any new hardware, or costly ETS software. **Consistently simple.**

With easy, all you need is an easy configuration server, a tablet and the easy app – and once you have those, you can create simple yet effective control solutions in real time. easy allows you to work quickly and reduces the amount of time you have to spend on programming. **Intuitive configuration.**

The system makes purchasing an intelligent building management system a worthwhile choice for even the average household. Not only that, but its modular nature also allows for expansion further down the line. You can plan ahead for your customers and help them to cut costs. **Efficient control.**



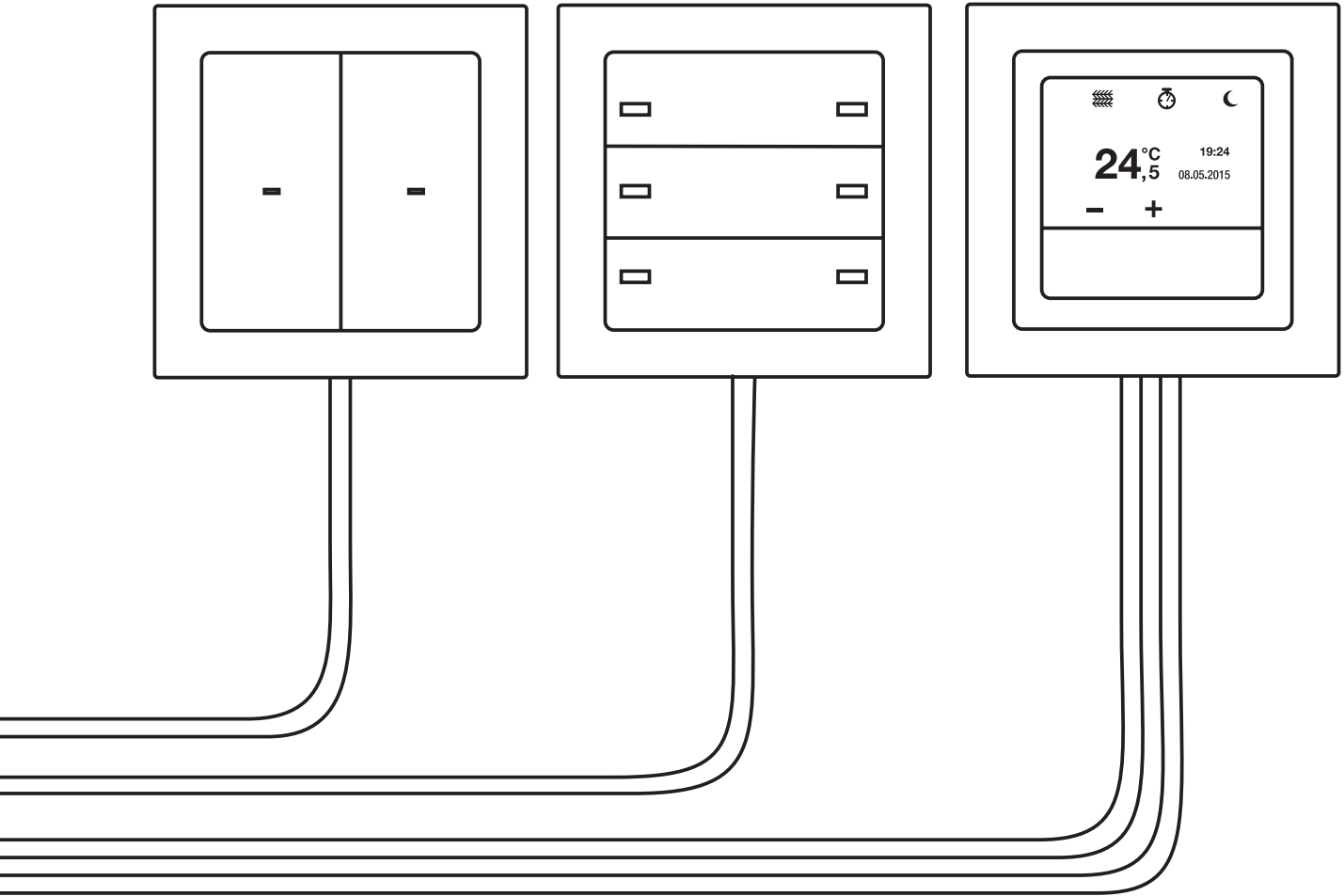

# Hager makes things easy

# KNX system range

KNX is an established standard everywhere, and one that our whole system range is fluent in. Any easy installation can be extended using quicklink wireless solutions or imported fully into the ETS software. Hager considers it essential that each one of its customers experiences this consistent concept, and by providing it, ensures they benefit from a solution that will hold up over the long term and offer as many expansion options as possible. **Guaranteed fit for the future.**

## Comparison of systems



### quicklink wireless modules

- Island solution for individual rooms
- Retrofitting of existing buildings



### easy configurations

- Complete solution for residential buildings
- Excellent functions for private households



### system programming

- Premium solution for residential buildings
- Meets complex requirements of functional buildings

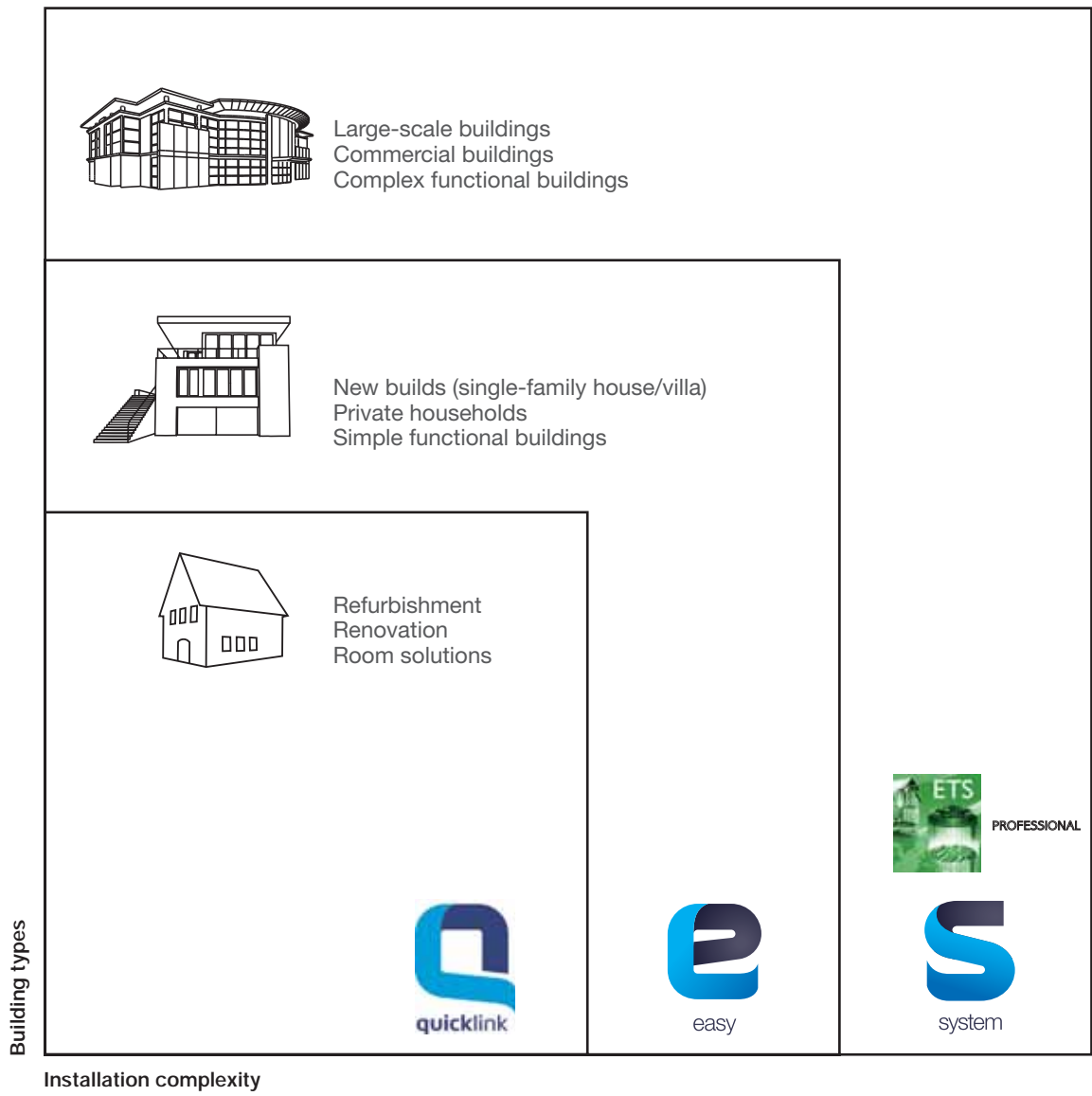

# Making it really easy To create an intelligent



You can program lighting scenarios to suit your customers' wishes, allowing them to create the atmosphere they are looking for quickly and easily. Dimming control for setting the mood.



Design, operation and functionality at the peak of perfection. Hager makes smart home solutions an affordable option for anyone, with technology that is making inroads into average private households. Your customers are sure to love the new level of convenience it affords them. Intelligent control centre.





# home



The system makes operating roller shutters and blinds convenient and so easy, even a child could do it. The option to shade or darken a space at the touch of a button creates more comfortable surroundings for your customers. **Raised potential.**

The option to switch everything off saves customers looking back over their shoulders after leaving the house. The simple control concept creates an intelligent home – even when the occupants are outside it. **Reassuring security solution.**



# easy installation

- Various installation options
- Clear range of devices

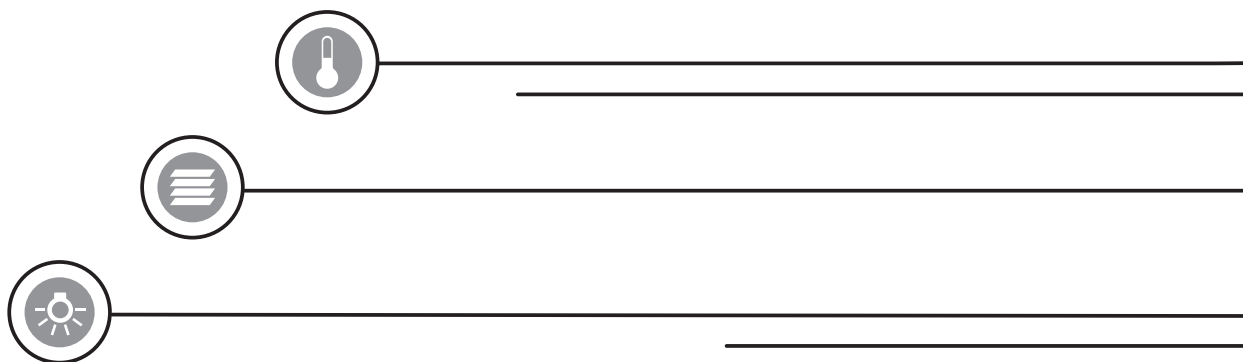

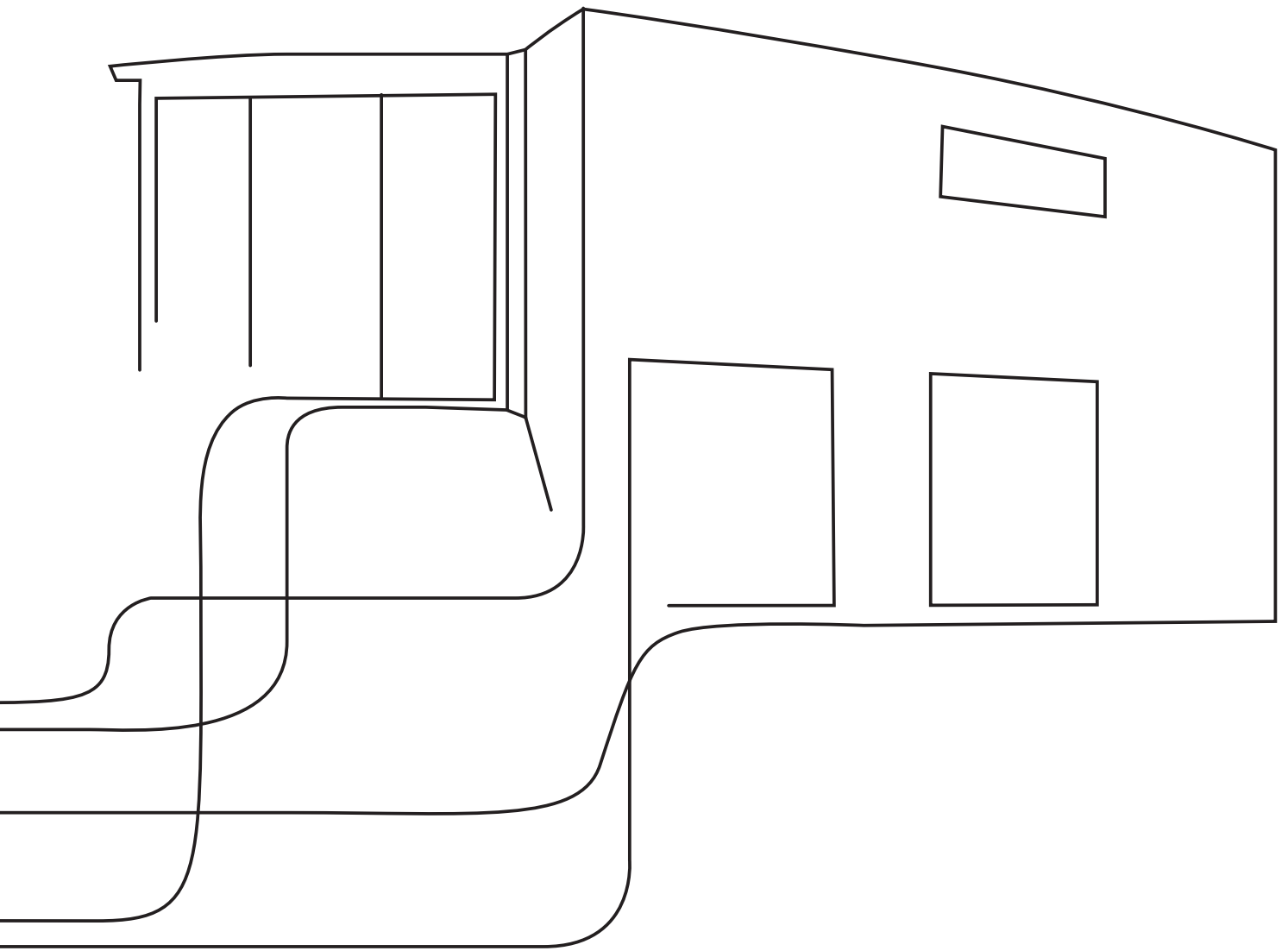

# easy installation

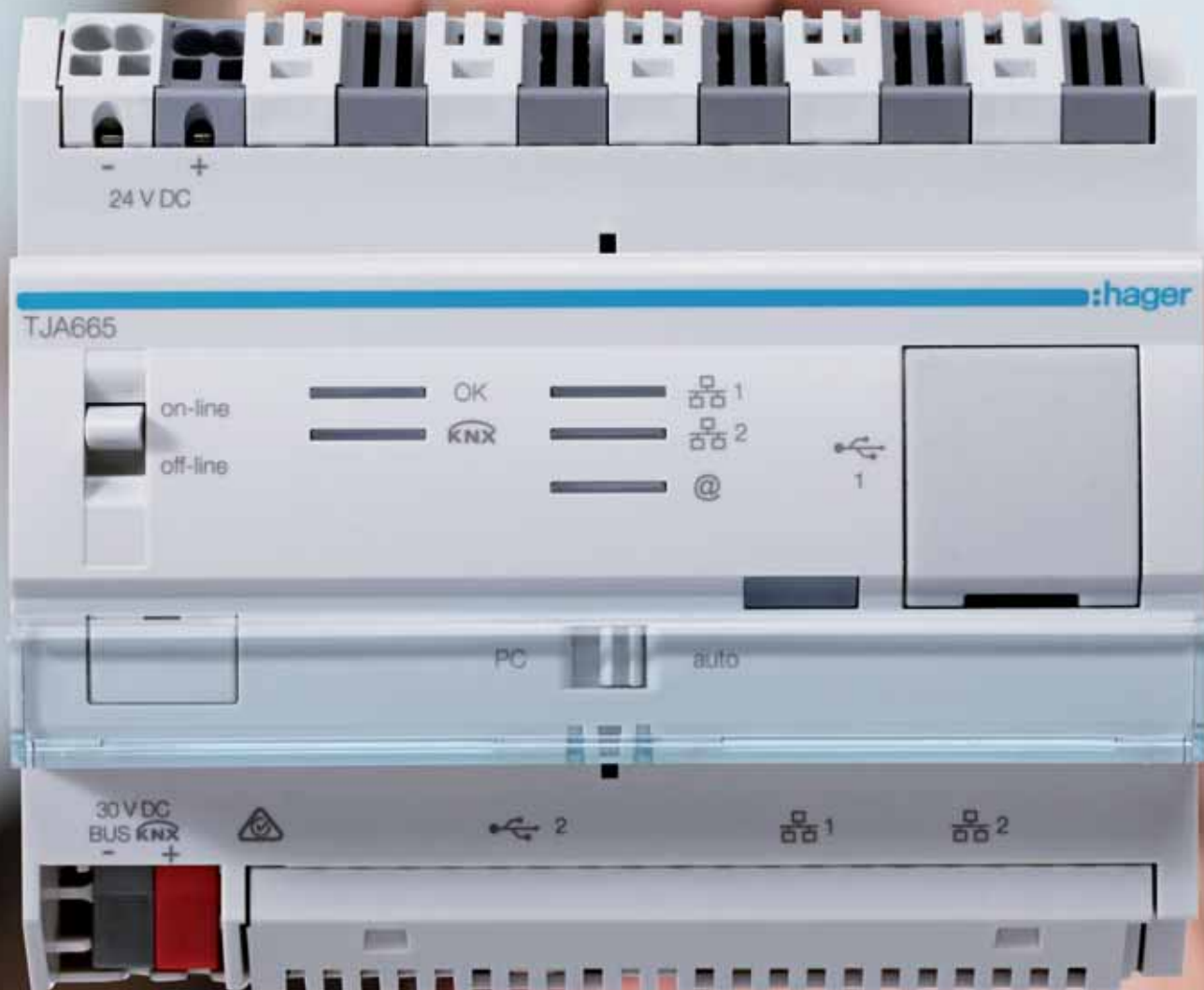

The easy configuration server is at the heart of the system. It is connected to the KNX system and acts as an intelligent partner during configuration. The easy configuration server forms the programming interface between the KNX installation and you while you are performing the configuration work on a tablet. Central management.

The new easy actuators are equipped with all the functions that residential buildings need – whether these involve switching lights on and off or dimming them, moving blinds, creating light scenes, or adapting to wind and weather conditions. easy systems come complete with all the security and comfort functions customers expect.

Visually speaking, the only way in which the easy actuators differ is their light-grey operation buttons – and inside the system, the easy functionality is virtually the sole difference.

Whether customers want to switch lights on and off and move blinds using combination actuators, or dim state-of-the-art lighting using dim actuators, easy actuators are capable of all this and more.



The new flush-mounted switching outputs are available as 1gang and 2gang switching outputs (in two versions). The 1gang output can be used for all types of lighting control – meaning not just switching lights on and off, but time, override, logic and scene functions too. With the 2gang output, there is the option of controlling two lighting circuits, a roller shutter/blind motor or a fan (2-stage activation).

A new feature comes in the form of the actuators that have been specifically developed for project business, which accommodate a high number of channels at an attractive price. In the 16gang and 20gang versions for lighting and blinds, as well as the 12gang versions for blinds at 230 V, they combine a large number of channels within a small space.



# easy products

## A place in the sun

The new easy actuators feature not only multifunctional binary outputs, but also specialist KNX blind outputs. Together with the new GPS weather station, this makes it possible to create a variety of comfort scenarios – including gradual roller shutter motions or blind slats that rotate in line with the sun. This both creates a more comfortable atmosphere for users and reduces lighting and heating costs.



## KNX weather station with GPS

The new weather station, featuring a GPS antenna, measures precipitation, temperature, wind speed and the sun's position with accuracy. Based on this information, convenient shade and heat protection functions – such as position tracking and sun tracking – can be configured for up to four building facades.

This allows blinds to be used for cooling in summer and sunlight to be used for heating in winter. It is also possible to program a rain, frost and wind alarm, with 3 stages in each case. The date, time and exact location coordinates are received via the GPS signal, and the station switches from summer to winter time automatically. The easy visualisation concept allows advanced functions to be added, such as set-point settings, process logic and timers. The weather station is mounted horizontally on the outer wall, enabling the sensors to detect sun, wind and rain without obstructions.

## KNX blind outputs

Five easy actuators with an option of 4, 8 or – a new addition – 12 outputs are available for activating roller shutter and blind motors. The 12gang output can normally be used to control any kind of shutters found in a small bungalow.

The 12gang output is supplied with 230 V. Depending on the rated voltage of the roller shutter and blind motors, the 4gang and 8gang outputs are available for either 230 V or a 24 V extra-low voltage.







# easy configuration

- State-of-the-art technology
- Automatic detection and reading-in of all KNX devices via the intelligent easy software
- Automatic connection via WLAN

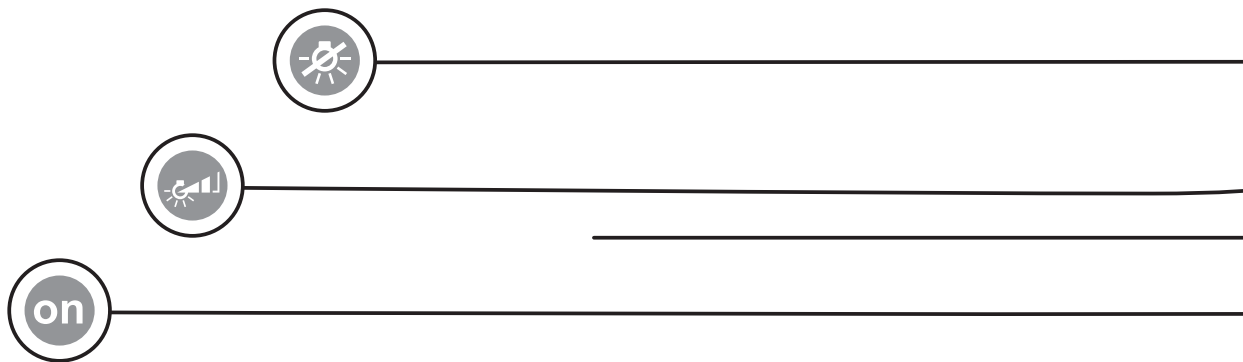



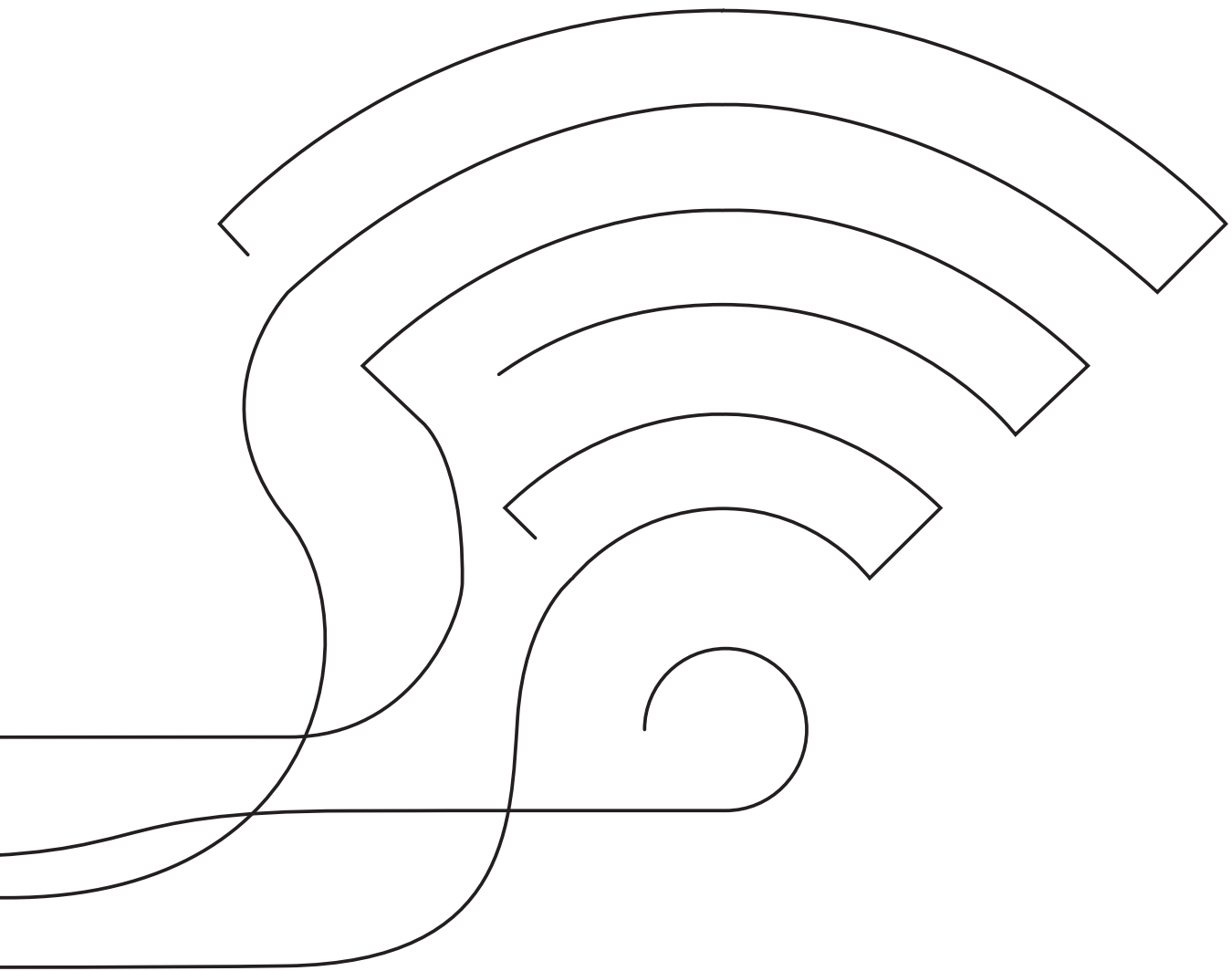

# easy configuration

KNX easy provides an intuitive means of configuring KNX systems. Just connect to the new easy service tool wirelessly using a tablet – and from that point, everything practically runs itself. **Brilliantly simple.**



## Step 1: Reading in

Once you have created a new project, activate the 'Start discovery' function. All the KNX products installed in the system, plus their inputs and outputs, will now be read in and listed according to their number. The software distinguishes between wired and radio products. This allows you to check whether all the installed devices have been detected.

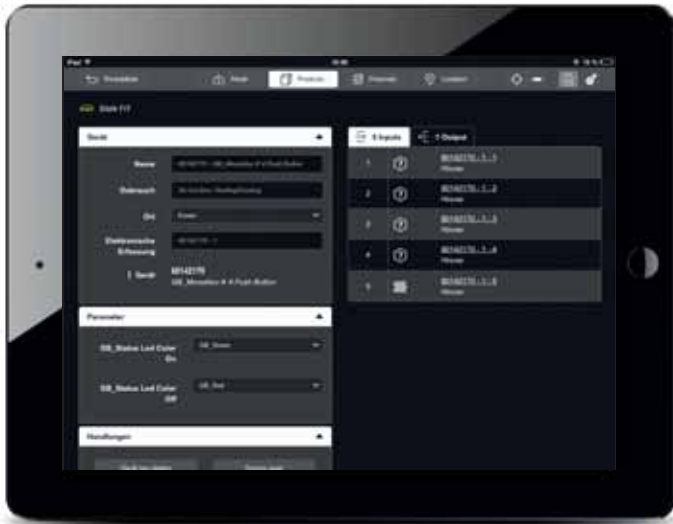

## Step 2: Labelling

easy speaks in plain language – meaning no abbreviated forms and no codes! You start by creating a simple name for the building, then giving names to each individual room and assigning the rooms to each floor. The next step is to label all the KNX products with all the inputs and outputs. Once the individual functions and their parameters have been defined, the inputs and outputs are assigned to the rooms that have been created.

## Step 3: Linking

You now select the inputs and outputs you require using the touchscreen function. You can simultaneously select multiple inputs and outputs that you wish to link. A filter function makes it possible to create quick and simple links for group switching, for instance.

Once you have selected the channels to be linked, press the 'Link' symbol.

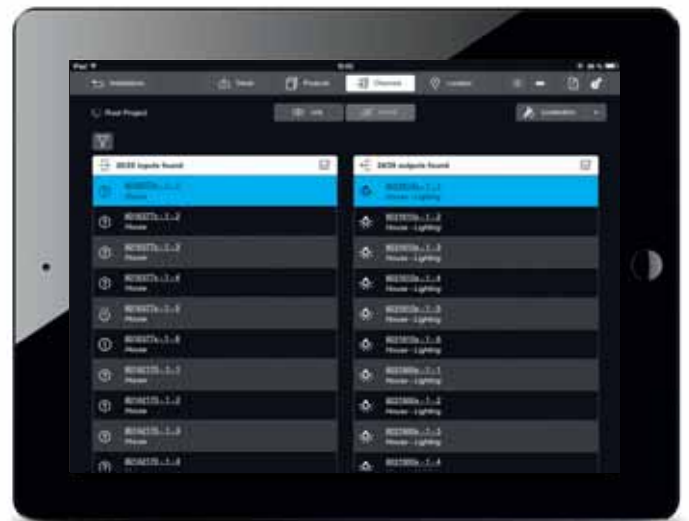

## Step 4: Function

The final step involves choosing the appropriate function. You may want the button to switch the lighting on or off, for example – but whatever the case, a whole range of KNX functions is available for selection. Once you have selected the function, operation can start immediately.

# easy visualisation

- Intuitive operation
- Attractive interface showing full building structure
- In-depth control and evaluation options

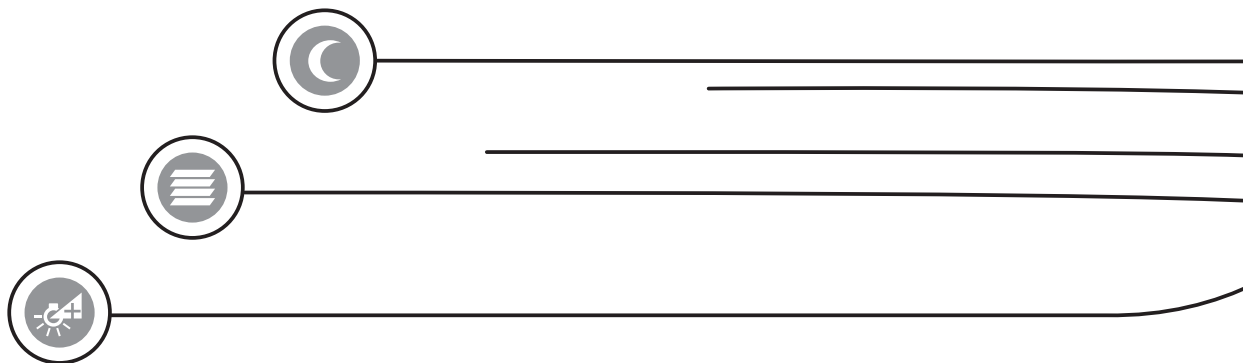

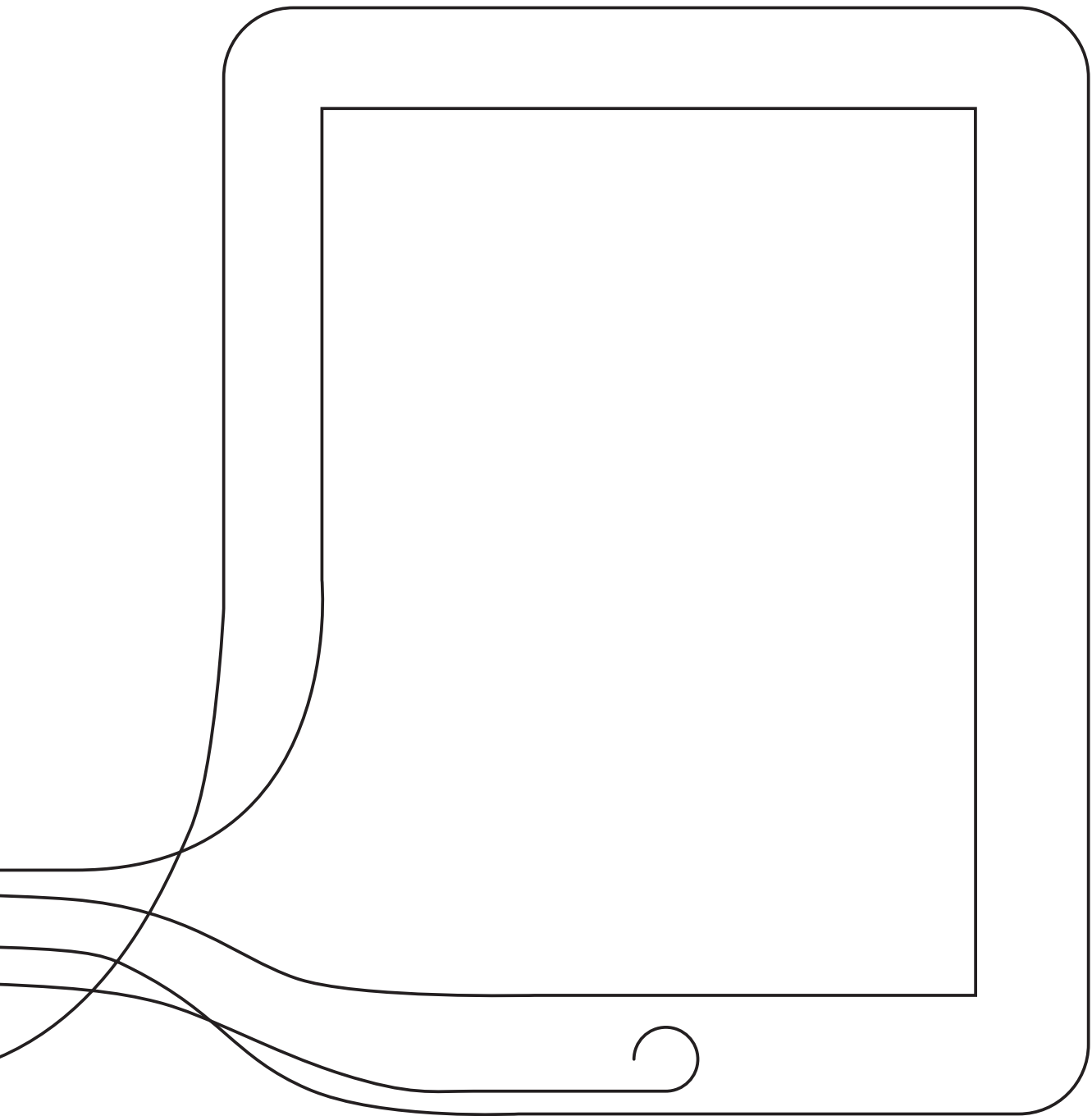

# easy visualisation

You've installed and configured the system – so now what? Your customers will undoubtedly want to establish the right setting for their building's architecture or create different lighting atmospheres for their home – all in next to no time and at the touch of a button. It's also likely that they are looking for a secure way of monitoring their property, even when they're away from it. Above all else, however, they are bound to want a tool for controlling their costs, which provides substantiated information, shows where potential savings can be made, and can be adjusted to ensure maximum efficiency and cost-effectiveness. **Clever solutions.**

The entire easy configuration can be imported into the domovea server via a USB stick. It is just as simple to read easy data into the ETS software later on, where it can be used to create more complex control functions. **Import data.**

The system can be controlled using a PC, tablet, smart-phone or the domovea Internet portal. For even better ease of use, there is the new touch panel range too. **Convenient control.**

The visualisation provides scope for further customisation, allowing personalised background images and symbols to be uploaded – and thus creating a unique user interface. **Beautifully personal.**

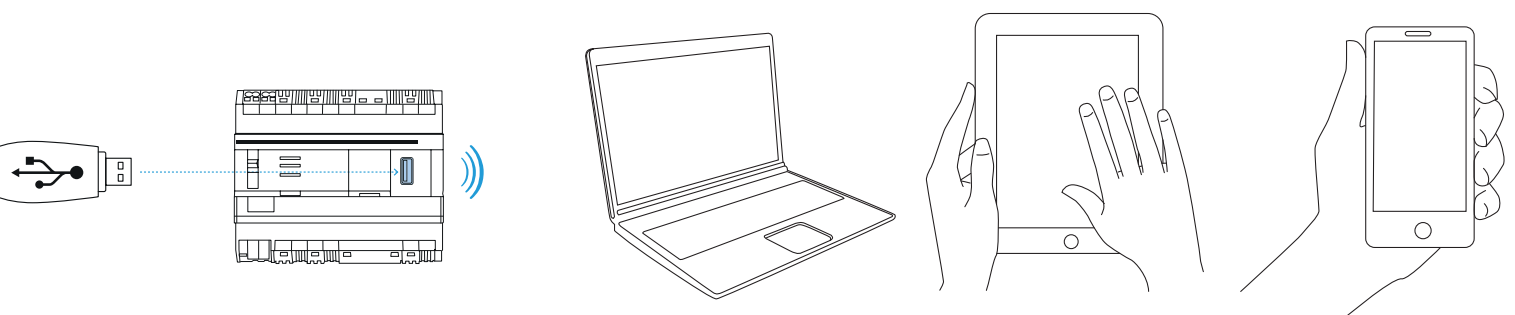



# easy operation

- New KNX sensors
- Familiar design lines
- Intelligent control
- Exceptionally convenient operation

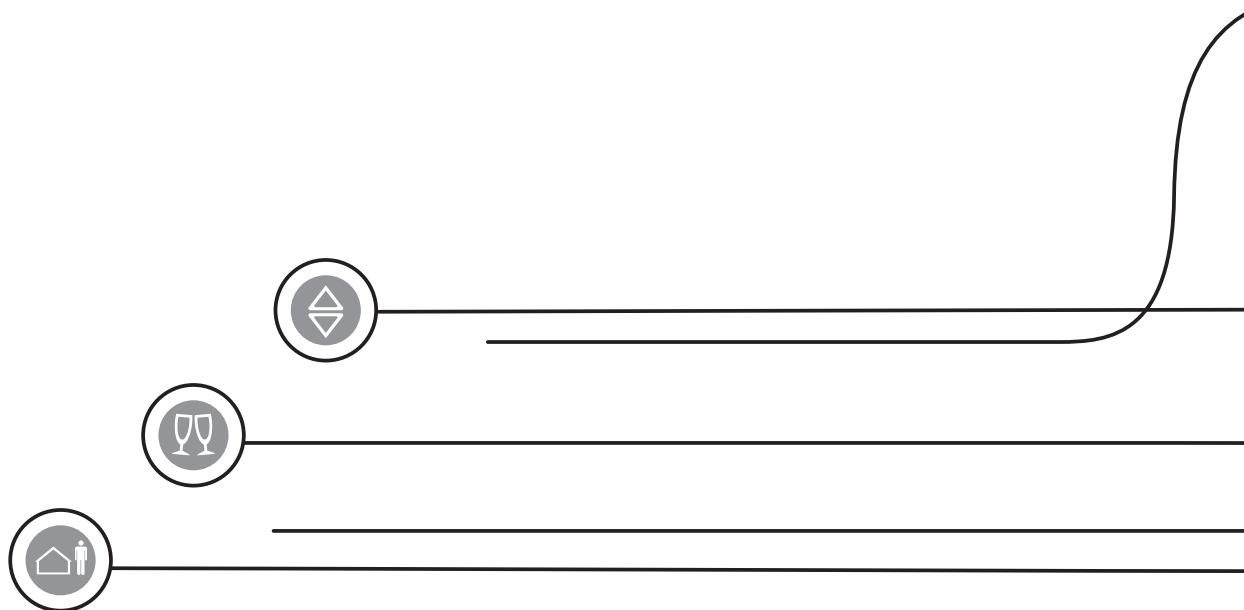



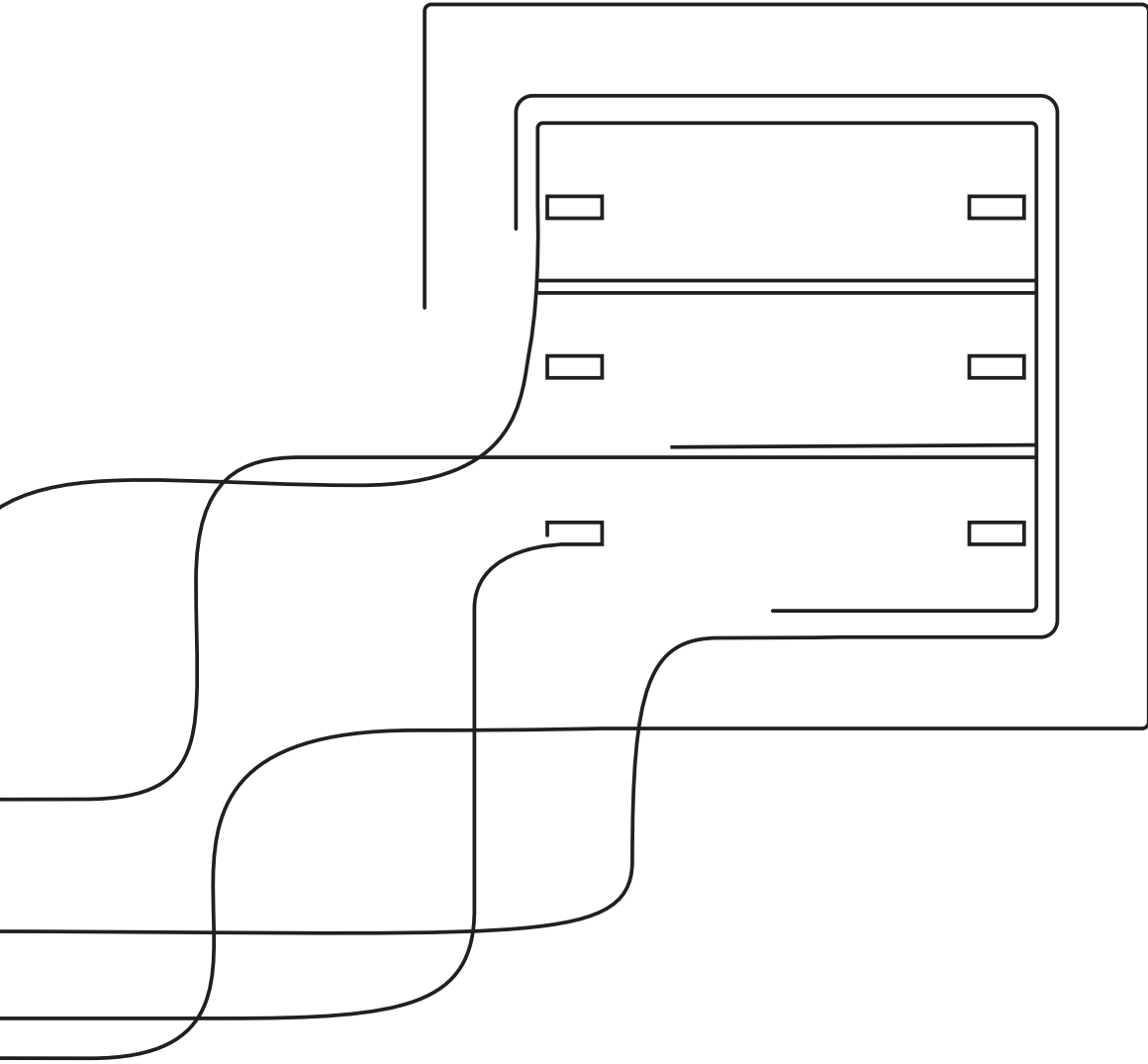

# easy operation

The new KNX sensors from Berker provide the perfect partners to easy actuators. Their design lines might be familiar, but they have a new stand-out feature – a reimagined sensibility. This allows customers to find the perfect solution to suit any need – from the attractively priced push-button option to the dimmable push-button, all the way through to the intuitive room controller. All the sensors can be combined with one another. **A versatile selection.**



## Switch, illuminate, protect

The new KNX push-buttons with integrated BCU (bus coupling unit) appear so simple from the outside, but are so smart on the inside: they easily connect to the in-house KNX system via the integrated bus coupling unit. Rockers in the centre allow the upper and lower push-button areas to be assigned separate functions. The 1gang push-button is able to trigger two control commands and the 2gang push-button four control commands. Each rocker has a status LED that also serves as orientation lighting. The LED colour can be customised as red, green or blue as well. And to stop any sticky fingers making off with such an appealing item, the push-button module and supporting ring can be bolted firmly together – the perfect thief deterrent.



## New: 1gang to 4gang KNX push-button

Switch on your senses. The new Berker KNX push-buttons make it possible to produce entire scenes and logic combinations. Users are also invited to use their senses of vision, hearing and touch, thanks to LEDs that can be dimmed in any required RGB colour combination, an integrated buzzer that can be felt when it is activated via the easy configuration, and a built-in temperature sensor to which a second sensor can be connected if required – for underfloor heating, to take one example. Available in the design lines S, B, Q, K and R in all standard colours.



# KNX room thermostat and room controller

The new Berker KNX room thermostat and room controller make an impact not once, but twice – thanks both to their attractive design and to their innovative operating concept featuring the wipe-and-type function that is exclusive to Berker. Simply wipe along the sensor strip and tap to select from a whole range of building functions. **Beautifully smart.**





# Product overview

## KNX Operating systems

### Push-buttons for standard and comfort ranges

- The configuration server (order no.: TJA665) or the tool set (order no.: TXA100) is required for easy commissioning via easy link.

#### Bus application unit flush-mounted



- external temperature sensor



Operating voltage over bus 21 ... 32 V=  
Operating temperature - 5 ... + 45 °C  
Insertion depth 32 mm

- with programming button and red programming LED
- additional connection for external temperature sensor
- with integrated buzzer for acoustic identification of the device within the system
- bus connection via connecting terminal
- with spreader claws

Suitable for optional	Order no.
KNX Configuration server easy link RMD	TJA665
KNX system package commissioning tool easy link RMD	TXA100
Temperature sensor	EK090

Design	Order no.	PU
Bus application unit flush-mounted	<b>8004 00 01</b>	1
Bus application unit flush-mounted	<b>8004 00 11</b>	1

#### Push-button 1gang



- labelling field
- RGB LED
- internal temperature sensor



Power consumption, KNX  $\approx$  150 mW  
Operating temperature - 5 ... + 45 °C  
Current consumption 20 mA

Use only in conjunction with bus coupling unit flush-mounted (order no.: 8004 00 x1)!

- with white operating LED
- Status LED configurable in 6 colours
- brightness value of the status LED for day/night-time operation preset, status LED for day/night-time operation can be controlled via object
- Operation LED can be configured via object
- Operating concepts for button function and "roller shutter/blind function" predefined
- Button functions: Switching, dimming, roller shutter/blind, timer, value transmitter 2 byte, thermostat extension unit, priority, scene, automatic control deactivation
- value transmitter for temperature values 2 byte
- switching of up to 64 scenes possible
- parameter definable lock function
- Function for incremental selection of up to 7 stored values
- Function for manual interruption of automatic functions already triggered
- integrated temperature sensor with output of the measured values via object
- for bus coupling unit flush-mounted
- alarm telegram after disconnection from bus coupling unit 1 bit or 1 byte
- with anti-dismantling protection

Suitable for optional	Order no.
Bus application unit flush-mounted	8004 00 ..
KNX Configuration server easy link RMD	TJA665
KNX system package commissioning tool easy link RMD	TXA100

Design	Order no.	PU
<b>Berker S.1/B.3/B.7</b>		
for white and polar white <sup>1)</sup>	<b>8016 17 80</b>	1
for anthracite and aluminium <sup>1)</sup>	<b>8016 17 85</b>	1

**Push-button 2gang**

- labelling fields
- RGB LED
- internal temperature sensor

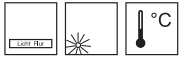

Power consumption, KNX                      ≈ 150 mW  
 Operating temperature                      - 5 ... + 45 °C  
 Current consumption                         20 mA

Use only in conjunction with bus coupling unit flush-mounted (order no.: 8004 00 x1)!

- with 2 status LEDs per rocker
- with white operating LED
- Status LED configurable in 6 colours
- brightness value of the status LED for day/night-time operation preset, status LED for day/night-time operation can be controlled via object
- Operation LED can be configured via object
- Operating concepts for button function and “roller shutter/blind function” predefined
- Button functions: Switching, dimming, roller shutter/blind, timer, value transmitter 2 byte, thermostat extension unit, priority, scene, automatic control deactivation
- value transmitter for temperature values 2 byte
- switching of up to 64 scenes possible
- parameter definable lock function
- Function for incremental selection of up to 7 stored values
- Function for manual interruption of automatic functions already triggered
- integrated temperature sensor with output of the measured values via object
- for bus coupling unit flush-mounted
- alarm telegram after disconnection from bus coupling unit 1 bit or 1 byte
- with anti-dismantling protection

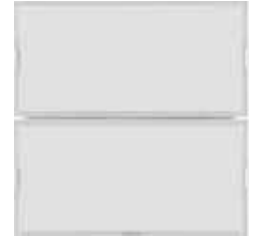

<b>Suitable for</b>	<b>Order no.</b>
Bus application unit flush-mounted	8004 00 ..
<b>optional</b>	
KNX Configuration server easy link RMD	TJA665
KNX system package commissioning tool easy link RMD	TXA100

Design	Order no.	PU
<b>Berker S.1/B.3/B.7</b>		
for white and polar white <sup>1)</sup>	<b>8016 27 80</b>	<b>1</b>
for anthracite and aluminium <sup>1)</sup>	<b>8016 27 85</b>	<b>1</b>

<sup>1)</sup> Labelling field length (W x H): 52.3 x 24.9 mm



**Push-button 3gang**

- labelling fields
- RGB LED
- horizontal operation

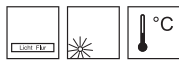

Power consumption, KNX  
Operating temperature  
Current consumption

≈ 150 mW  
- 5 ... + 45 °C  
20 mA

Use only in conjunction with bus coupling unit flush-mounted (order no.: 8004 00 x1)!

- with 2 status LEDs per rocker
- with white operating LED
- Status LED configurable in 6 colours
- brightness value of the status LED for day/night-time operation preset, status LED for day/night-time operation can be controlled via object
- Operation LED can be configured via object
- Operating concepts for button function and "roller shutter/blind function" predefined
- Button functions: Switching, dimming, roller shutter/blind, timer, value transmitter 2 byte, thermostat extension unit, priority, scene, automatic control deactivation
- value transmitter for temperature values 2 byte
- switching of up to 64 scenes possible
- parameter definable lock function
- Function for incremental selection of up to 7 stored values
- Function for manual interruption of automatic functions already triggered
- integrated temperature sensor with output of the measured values via object
- for bus coupling unit flush-mounted
- alarm telegram after disconnection from bus coupling unit 1 bit or 1 byte
- with anti-dismantling protection

<b>Suitable for</b>	<b>Order no.</b>
Bus application unit flush-mounted	8004 00 ..
<b>optional</b>	
KNX Configuration server easy link RMD	TJA665
KNX system package commissioning tool easy link RMD	TXA100

Design	Order no.	PU
<b>Berker S.1/B.3/B.7</b>		
for white and polar white <sup>1)</sup>	<b>8016 37 80</b>	<b>1</b>
for anthracite and aluminium <sup>1)</sup>	<b>8016 37 85</b>	<b>1</b>

<sup>1)</sup> Labelling field length (W x H): 52.3 x 15.6 mm



**Push-button 4gang**

- labelling fields
- RGB LED
- internal temperature sensor

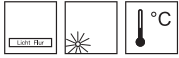

Power consumption, KNX	≈ 150 mW
Operating temperature	- 5 ... + 45 °C
Current consumption	20 mA

Use only in conjunction with bus coupling unit flush-mounted  
(order no.: 8004 00 x1)!

In the design line S.1/B.x and K.x only use in conjunction with a frame with large cut-out!

- with 2 status LEDs per rocker
- with white operating LED
- Status LED configurable in 6 colours
- brightness value of the status LED for day/night-time operation preset, status LED for day/night-time operation can be controlled via object
- Operation LED can be configured via object
- Operating concepts for button function and "roller shutter/blind function" predefined
- Button functions: Switching, dimming, roller shutter/blind, timer, value transmitter 2 byte, thermostat extension unit, priority, scene, automatic control deactivation
- value transmitter for temperature values 2 byte
- switching of up to 64 scenes possible
- parameter definable lock function
- Function for incremental selection of up to 7 stored values
- Function for manual interruption of automatic functions already triggered
- integrated temperature sensor with output of the measured values via object
- for bus coupling unit flush-mounted
- alarm telegram after disconnection from bus coupling unit 1 bit or 1 byte
- with anti-dismantling protection

Suitable for	Order no.
Bus application unit flush-mounted	8004 00 ..
<b>optional</b>	
KNX Configuration server easy link RMD	TJA665
KNX system package commissioning tool easy link RMD	TXA100

Design	Order no.	PU
<b>Berker S.1/B.3/B.7</b>		
for white and polar white <sup>1)</sup>	<b>8016 47 80</b>	<b>1</b>
for anthracite and aluminium <sup>1)</sup>	<b>8016 47 85</b>	<b>1</b>

<sup>1)</sup> Labelling field length (W x H): 52.3 x 24.9 mm



**Push-button modules**

- The configuration server (order no.: TJA665) or the tool set (order no.: TXA100) is required for easy commissioning via easy link.



**Push-button module 1gang**

- RGB LED
- internal temperature sensor
- integrated bus coupling unit



Operating voltage over bus	21 ... 32 V=
Current consumption	10 mA
Operating temperature	- 5 ... + 45 °C
Insertion depth	32 mm

- Status LED configurable in 6 colours
- brightness value of the status LED for day/night-time operation preset, status LED for day/night-time operation can be controlled via object
- Operation LED can be configured via object
- Operating concepts for button function and "roller shutter/blind function" predefined
- Push-button functions: Switching, dimming, roller shutter/blind, value transmitter 2 byte, thermostat, scene, priority
- value transmitter for temperature values 2 byte
- parameter definable lock function
- Function for manual interruption of automatic functions already triggered
- with programming button and red programming LED
- integrated temperature sensor with output of the measured values via object
- with integrated bus coupling unit
- bus connection via connecting terminal
- with anti-dismantling protection
- with integrated buzzer for acoustic identification of the device within the system

<b>Suitable for</b>	<b>Order no.</b>
Cover for 1gang for push-button module optional	8096 02 ..
KNX Configuration server easy link RMD	TJA665
KNX system package commissioning tool easy link RMD	TXA100
Temperature sensor	EK090 ..

Design	Order no.	PU
<b>Berker S.1/B.3/B.7</b>		
Push-button module 1gang	<b>8014 11 80</b>	<b>1</b>



**Cover for 1gang for push-button module**

- clear lens



- with clear lens for RGB status display of the push-button module

<b>Suitable for</b>	<b>Order no.</b>
Push-button module 1gang	8014 11 ..
Order no.	PU

Design	Order no.	PU
<b>Berker S.1/B.3/B.7</b>		
white glossy	<b>8096 02 82</b>	<b>1</b>
polar white glossy	<b>8096 02 89</b>	<b>1</b>
polar white, matt, plastic	<b>8096 02 99</b>	<b>1</b>
anthracite, matt	<b>8096 02 85</b>	<b>1</b>
aluminium, matt, lacquered	<b>8096 02 83</b>	<b>1</b>

**Push-button module 2gang**

- RGB LED
- internal temperature sensor
- integrated bus coupling unit

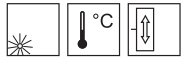

Operating voltage over bus  
Current consumption  
Operating temperature  
Insertion depth

21 ... 32 V=  
10 mA  
- 5 ... + 45 °C  
32 mm

- Status LED configurable in 6 colours
- brightness value of the status LED for day/night-time operation preset, status LED for day/night-time operation can be controlled via object
- Operation LED can be configured via object
- Operating concepts for button function and "roller shutter/blind function" predefined
- Push-button functions: Switching, dimming, roller shutter/blind, value transmitter 2 byte, thermostat, scene, priority
- value transmitter for temperature values 2 byte
- parameter definable lock function
- Function for manual interruption of automatic functions already triggered
- with programming button and red programming LED
- integrated temperature sensor with output of the measured values via object
- with integrated bus coupling unit
- bus connection via connecting terminal
- with anti-dismantling protection
- with integrated buzzer for acoustic identification of the device within the system



<b>Suitable for</b>	<b>Order no.</b>
Cover for 2gang for push-button module	8096 03 ..
<b>optional</b>	
KNX Configuration server easy link RMD	TJA665
KNX system package commissioning tool easy link RMD	TXA100
Temperature sensor	EK090 ..

Design

Order no.

PU

**Berker S.1/B.3/B.7**

Push-button module 2gang

**8014 21 80**

1

**Cover for 2gang for push-button module**

- clear lenses



- with 2 clear lenses for the RGB status display of the push-button module

<b>Suitable for</b>	<b>Order no.</b>
Push-button module 2gang	8014 21 ..

Design

Order no.

PU

**Berker S.1/B.3/B.7**

white glossy  
polar white glossy  
polar white, matt, plastic  
anthracite, matt  
aluminium, matt, lacquered

**8096 03 82**  
**8096 03 89**  
**8096 03 99**  
**8096 03 85**  
**8096 03 83**

1  
1  
1  
1  
1



**Berker S.1 frames**



**Frame**

Design	Order no.	PU
Frame 1gang, white glossy, 1gang	<b>1011 89 82</b>	1



**Frame**

Design	Order no.	PU
Frame 1gang, polar white glossy, 1gang	<b>1011 89 89</b>	1



**Frame**

Design	Order no.	PU
Frame 1gang, anthracite matt, 1gang	<b>1011 99 49</b>	1



**Frame**

Design	Order no.	PU
Frame 1gang, aluminium matt, 1gang	<b>1011 99 39</b>	1



**Frame**

Design	Order no.	PU
Frame 1gang, red glossy, 1gang	<b>1011 89 62</b>	1

- for emphasising special switches, socket outlets, etc.
- for vertical and horizontal mounting

**Frame with large cut-out**

- For vertical mounting
- Not suitable for surface-mounted housing.

**Frame with large cut-out**

Design	Order no.	PU
white glossy	<b>1309 89 82</b>	1



**Frame with large cut-out**

Design	Order no.	PU
polar white glossy	<b>1309 89 89</b>	1
polar white matt	<b>1309 99 09</b>	1



**Frame with large cut-out**

Design	Order no.	PU
anthracite matt	<b>1309 99 49</b>	1



**Frame with large cut-out**

Design	Order no.	PU
aluminium matt	<b>1309 99 39</b>	1



**Berker B.3 frames**

- For vertical and horizontal mounting
- Metal, aluminum profile



**Frame**

Design	Order no.	PU
Aluminium/polar white matt, aluminium anodised, 1gang	<b>1011 39 04</b>	1



**Frame**

Design	Order no.	PU
aluminium/anthracite matt, aluminium anodised, 1gang	<b>1011 30 04</b>	1



**Frame**

Design	Order no.	PU
Aluminium black/polar white matt, aluminium anodised, 1gang	<b>1011 30 25</b>	1



**Frame**

Design	Order no.	PU
Aluminium black/anthracite matt, aluminium anodised, 1gang	<b>1011 30 05</b>	1



**Frame**

Design	Order no.	PU
Aluminium brown/polar white matt, aluminium anodised, 1gang	<b>1011 30 21</b>	1

**Frame**

Design	Order no.	PU
Aluminium brown/anthracite matt, aluminium anodised, 1gang	<b>1011 30 01</b>	1



**Frame**

Design	Order no.	PU
Aluminium red/polar white matt, aluminium anodised, 1gang	<b>1011 30 22</b>	1



**Frame**

Design	Order no.	PU
Aluminium red/anthracite matt, aluminium anodised, 1gang	<b>1011 30 12</b>	1

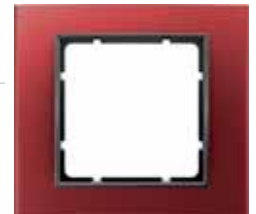

**Frame**

Design	Order no.	PU
Aluminium gold/polar white matt, aluminium anodised, 1gang	<b>1011 30 46</b>	1



**Frame**

Design	Order no.	PU
Aluminium gold/anthracite matt, aluminium anodised, 1gang	<b>1011 30 16</b>	1



**Frame with large cut-out**

- For vertical mounting
- Metal, aluminum profile
- Not suitable for surface-mounted housing.



**Frame with large cut-out**

Design	Order no.	PU
Aluminium/polar white matt, aluminium anodised	<b>1309 39 04</b>	1



**Frame with large cut-out**

Design	Order no.	PU
aluminium/anthracite matt, aluminium anodised	<b>1309 30 04</b>	1



**Frame with large cut-out**

Design	Order no.	PU
Aluminium black/polar white matt, aluminium anodised	<b>1309 30 25</b>	1



**Frame with large cut-out**

Design	Order no.	PU
Aluminium black/anthracite matt, aluminium anodised	<b>1309 30 05</b>	1



**Frame with large cut-out**

Design	Order no.	PU
Aluminium brown/polar white matt, aluminium anodised	<b>1309 30 21</b>	1



**Frame with large cut-out**

Design	Order no.	PU
Aluminium brown/anthracite matt, aluminium anodised	<b>1309 30 01</b>	1



**Frame with large cut-out**

Design	Order no.	PU
Aluminium red/polar white matt, aluminium anodised	<b>1309 30 22</b>	1



**Frame with large cut-out**

Design	Order no.	PU
Aluminium red/anthracite matt, aluminium anodised	<b>1309 30 12</b>	1



**Frame with large cut-out**

Design	Order no.	PU
Aluminium gold/polar white matt, aluminium anodised	<b>1309 30 46</b>	1

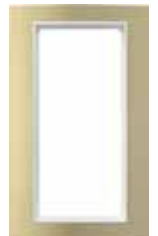

**Frame with large cut-out**

Design	Order no.	PU
Aluminium gold/anthracite matt, aluminium anodised	<b>1309 30 16</b>	1



### Berker B.7 frames

- Not suitable for surface-mounted housing
- For vertical and horizontal mounting

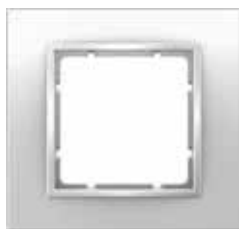

#### Frame

- plastic

Design	Order no.	PU
polar white matt, 1gang	<b>1011 69 19</b>	1



#### Frame

- plastic

Design	Order no.	PU
anthracite matt, 1gang	<b>1011 66 26</b>	1



#### Frame

- plastic

Design	Order no.	PU
aluminium matt, lacquered, 1gang	<b>1011 64 24</b>	1



#### Frame

- metal, aluminum profile anodized

Design	Order no.	PU
Aluminium/polar white matt, aluminium anodised, 1gang	<b>1011 69 14</b>	1



#### Frame

- metal, aluminum profile anodized

Design	Order no.	PU
aluminium/anthracite matt, aluminium anodised, 1gang	<b>1011 69 04</b>	1

**Frame**

metal, stainless steel, brushed

Design	Order no.	PU
Stainless steel/polar white matt, metal brushed, 1gang	<b>1011 36 09</b>	1



**Frame**

– metal, stainless steel, brushed

Design	Order no.	PU
Stainless steel/anthracite matt, metal brushed, 1gang	<b>1011 36 06</b>	1



**Frame**

– toughened glass

Design	Order no.	PU
glass polar white/polar white matt, 1gang	<b>1011 69 09</b>	1



**Frame**

– toughened glass

Design	Order no.	PU
glass black/anthracite matt, 1gang	<b>1011 66 16</b>	1





**Frame**

	– toughened glass	
Design	Order no.	PU
glass aluminium/aluminium matt, lacquered, 1gang	<b>1011 64 14</b>	1

**Frame with large cut-out**

- For vertical mounting
- Not suitable for surface-mounted housing.



**Frame with large cut-out**

	– plastic	
Design	Order no.	PU
polar white matt, lacquered	<b>1309 69 19</b>	1



**Frame with large cut-out**

	– plastic	
Design	Order no.	PU
anthracite matt, lacquered	<b>1309 66 26</b>	1



**Frame with large cut-out**

	– plastic	
Design	Order no.	PU
aluminium matt, lacquered	<b>1309 64 24</b>	1



**Frame with large cut-out**

	– metal, aluminum profile anodized	
Design	Order no.	PU
Aluminium/polar white matt, aluminium anodised	<b>1309 69 14</b>	1

**Frame with large cut-out**

	– metal, aluminum profile anodized	
Design	Order no.	PU
aluminium/anthracite matt, aluminium anodised	<b>1309 69 04</b>	1



**Frame with large cut-out**

	– stainless steel surface, brushed transversely	
Design	Order no.	PU
Stainless steel/polar white matt, metal brushed	<b>1309 36 09</b>	1



**Frame with large cut-out**

	– stainless steel surface, brushed transversely	
Design	Order no.	PU
Stainless steel/anthracite matt, metal brushed	<b>1309 36 06</b>	1



**Glass frame with large cut-out**

	– toughened glass	
Design	Order no.	PU
glass polar white/polar white matt	<b>1309 36 06</b>	1



**Glass frame with large cut-out**

	– toughened glass	
Design	Order no.	PU
glass black/anthracite matt	<b>1309 66 16</b>	1



**Glass frame with large cut-out**

	– toughened glass	
Design	Order no.	PU
glass aluminium/aluminium matt, lacquered	<b>1309 64 14</b>	1



# systo tebis wired pushbuttons

systo tebis offers a unique combination between the embedded intelligence and design. It has the ability to easily integrate KNX functions at the heart of your projects. systo tebis wired pushbuttons allow you to assign a LED colour to a function, refine the energy efficiency of a building, condition the use of controls based on defined criteria, and identify control points in the dark.



## 01

### One product, 3 functions

- control
- measures temperature
- visualisation



## 02

### Scalability

2, 4 or 6 buttons : you can easily change the number of buttons on a switch to add more functions without rewiring



# 03

## Status feedback

Status feedback given by 6 LED colours

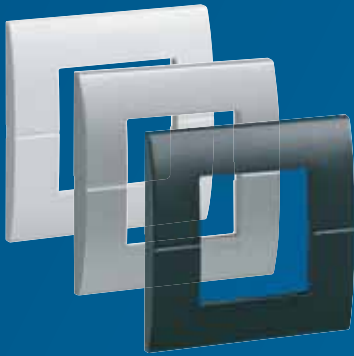

# 04

## 3 colours available

3 colours available  
White, titanium, black to suit all environments



# 05

## IR sensor optional



# 06





## Adaptable backlight

Adaptable backlight setting

### Bus mechanisms

Wired systo tebis mechanisms are mounted in a WS4xx frame. The connection is made using two wires on the bus. Functions are freely programmable and modifiable.

Composition: The mechanisms are supplied ready for use.

	Description	Characteristics	Colour	Cat ref.
	<b>Mechanisms for pushbutton KNX bus functions :</b> - On/Off, change - up/down - forcing, scenarios - temperature probe - signalling, status feedback 9 colours	supply: Bus 30 V DC		
WST302				
	2 buttons		white	WST302
			black	WST302N
			silver	WST302T
WST304	4 buttons		white	WST304
			black	WST304N
			silver	WST304T
	6 buttons		white	WST306
			black	WST306N
			silver	WST306T
WST306	2 LED buttons	LED status indication	white	WST312
			black	WST312N
			silver	WST312T
	4 LED buttons	LED status indication	white	WST314
			black	WST314N
			silver	WST314T
	6 LED buttons	LED status indication	white	WST316
			black	WST316N
			silver	WST316T
WST316				





**Infrared bus mechanisms**

Wired systo tebis mechanisms are mounted in a WS4xx frame. The connection is made using two wires on the bus. Functions are freely programmable and modifiable.

Composition: The mechanisms are delivered ready to use

It is possible to control a tebis installation with most universal remotes.

Description	Characteristics	Colour	Cat. ref.	
<b>Mechanisms for pushbutton KNX bus infrared</b>		supply : Bus 30 V DC		
functions :				
- On/Off, change				
- up/down				
- forcing, scenarios				
- temperature probe				
- signaling, status feedback 9 colours				
2 buttons + 12 infrared inputs		white	WST322	
		black	WST322N	
		silver	WST322T	
WST322				
4 buttons + 12 infrared inputs		white	WST324	
		black	WST324N	
		silver	WST324T	
WST324				

**Plate clips**

UV resistant material with an anti-static surface. Adjustable to the millimeter thanks to clipping notches. Extracting slots on the sides.

	Description	Characteristics	PU	Cat. ref.
 WS401	<b>White plates</b>	dim. : 80 x 80 mm	1	<b>WS401</b>
 WS401T	<b>Aluminium plates</b>	dim. : 80 x 80 mm	1	<b>WS401T</b>
 WS401N	<b>Black plates</b>	dim. : 80 x 80 mm	1	<b>WS401N</b>

**Frames**

For use with 45 x 45 mechanisms.

Glow wire tests according to TNF EN 60695-2

---

Description	Characteristics	PU	Cat ref.
-------------	-----------------	----	----------

---

<b>Frames</b>		1	WS450Y
---------------	--	---	--------



WS450Y

- Complies with BS EN 606691-1 switches, BS 5733 fuse carrier.
- Shallowest switch modules for ease of installation.
- Modules clip from the front for ease of installation and maintenance.
- Terminal screw can be accessed with modules clipped into frames.
- Frames locate to finished wall level.
- Frames clip to ease alignment for 6 gang and 8 gang applications.
- WR references supplied with M3.5x30mm long fixing screws.
- WF references supplied with M3.5x20mm long fixing screws.



WMGS13R

Grid Central Off Switch Series	Retractive	
	White	Black
20A 2 Way Retractive Switch	WMGS22R	-
2 Way & Centre Off Grid Swith	WMGS13R	WMGS13RB
2 Way & Centre Off / Red Rocker	WMGS13RR	-

## sollysta - decorative

### Grid plates



WMGP3

	Plate Finish	White Moulded
<b>Raised Plate</b>		
1 Gang Grid Plate		WMGP1
2 Gang Grid Plate		WMGP2
3 Gang Grid Plate		WMGP3
4 Gang Grid Plate		WMGP4
6 Gang ( 2 X 3 ) Grid Plate		WMGP6
8 Gang ( 2 X 4 ) Grid Plate		WMGP8



WFGP1PS

	Plate Finish	Polished Steel
<b>Raised Plate</b>		
1 Gang Grid Plate		WRGP1PS
2 Gang Grid Plate		WRGP2PS
3 Gang Grid Plate		WRGP3PS
4 Gang Grid Plate		WRGP4PS
6 Gang ( 2 X 3 ) Grid Plate		WRGP6PS
8 Gang ( 2 X 4 ) Grid Plate		WRGP8PS
12 Gang ( 3 X 4 ) Grid Plate		WRGP12PS
<b>Flat Plate</b>		
1 Gang Grid Plate		WFGP1PS
2 Gang Grid Plate		WFGP2PS
3 Gang Grid Plate		WFGP3PS
4 Gang Grid Plate		WFGP4PS
6 Gang ( 2 X 3 ) Grid Plate		WFGP6PS
8 Gang ( 2 X 4 ) Grid Plate		WFGP8PS
12 Gang ( 3 X 4 ) Grid Plate		WFGP12PS

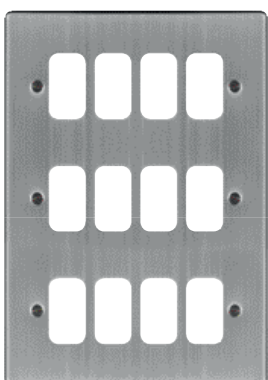

WRGP12PS

Frame Size	1 Gang Frame	2 Gang Frame	3 / 4 Gang Frame
Frames for White Moulded and Decorative Raised Plate ranges	<b>WMGF1</b>	<b>WMGF2</b>	<b>WMGF34</b>
Frames for Decorative Flat Plate ranges	<b>WFGF1</b>	<b>WFGF2</b>	<b>WFGF34</b>



WMGF34

	Brushed Steel	Black Nickel
	<b>WRGP1BS</b>	<b>WRGP1BN</b>
	<b>WRGP2BS</b>	<b>WRGP2BN</b>
	<b>WRGP3BS</b>	<b>WRGP3BN</b>
	<b>WRGP4BS</b>	<b>WRGP4BN</b>
	<b>WRGP6BS</b>	<b>WRGP6BN</b>
	<b>WRGP8BS</b>	<b>WRGP8BN</b>
	<b>WRGP12BS</b>	<b>WRGP12BN</b>
	<b>WFGP1BS</b>	<b>WFGP1BN</b>
	<b>WFGP2BS</b>	<b>WFGP2BN</b>
	<b>WFGP3BS</b>	<b>WFGP3BN</b>
	<b>WFGP4BS</b>	<b>WFGP4BN</b>
	<b>WFGP6BS</b>	<b>WFGP6BN</b>
	<b>WFGP8BS</b>	<b>WFGP8BN</b>
	<b>WFGP12BS</b>	<b>WFGP12BN</b>

**KNX thermostat**

- The configuration server (order no.: TJA665) or the tool set (order no.: TXA100) is required for easy commissioning via easy link.



**KNX thermostat**

- display
- integrated bus coupling unit



Operating voltage over bus	21 ... 32 V=
Auxiliary voltage	24 V=
Energy efficiency class	IV (2%)
TFT screen size	1.93"
Operating temperature	- 5 ... + 45 °C
Dimensions of display (W x H)	38.3 x 30.3 mm
Insertion depth	32 mm

- for individual single room temperature control
- control parameter for heating / cooling unit pre-set
- operating mode heating, cooling or heating/cooling can be selected
- Comfort, standby, night-time reduction, frost/heat protection operating mode switchable via scene
- Switching PI-control (PWM) or switching 2-point control can be selected
- Heating type warm water heating, warm water under-floor heating, electric heating, electric underfloor heating or split unit can be selected
- Cooling type cooling ceiling, convector fan or split unit can be selected
- switching of up to 64 scenes possible
- with keylock
- with holiday switching
- with frost protection function
- additional connection for external temperature sensor
- Temperature measurement via internal, external temperature sensor or via object and their mean value formation
- Temperature adjustable for comfort, standby and night-time reduction
- operation via sensitive Touch control surface
- to display and initiate actions
- display of operating mode, controller lockout, room/ outside temperature, time
- screen-savers
- TFT colour display with symbol display
- time and date display
- Menu guidance in DE/EN/FR/NL/IT/ES/PT/PL/DK/SV/FI/NO/TR
- with integrated bus coupling unit
- bus connection via connecting terminal
- with spreader claws

<b>Suitable for</b>	<b>Order no.</b>
Cover for KNX thermostats and room controllers	8096 01 ..
KNX power supply 2 x 320 mA + 24 V DC, 640 mA RMD	TXA114
Electrical power supply 24 V DC RMD	TGA200
<b>optional</b>	
KNX system package commissioning tool easy link RMD	TXA100
KNX Configuration server easy link RMD	TJA665
Temperature sensor	EK090

Design	Order no.	PU
KNX thermostat	<b>8044 01 00</b>	<b>1</b>

## KNX room controller

- display
- integrated bus coupling unit

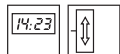

Operating voltage over bus	21 ... 32 V=
Auxiliary voltage	24 V=
Energy efficiency class	IV (2%)
TFT screen size	1.93"
Operating temperature	- 5 ... + 45 °C
Dimensions of display (W x H)	38.3 x 30.3 mm
Insertion depth	32 mm

- for individual single room temperature control
- control parameter for heating / cooling unit pre-set
- operating mode heating, cooling or heating/cooling can be selected
- Comfort, standby, night-time reduction, frost/heat protection operating mode switchable via scene
- Switching PI-control (PWM) or switching 2-point control can be selected
- Heating type warm water heating, warm water under-floor heating, electric heating, electric underfloor heating or split unit can be selected
- Cooling type cooling ceiling, convector fan or split unit can be selected
- Push-button functions: Switching, dimming, roller shutter/blind, value transmitter 2 byte, thermostat, scene, priority
- switching of up to 64 scenes possible
- with keylock
- with holiday switching
- with frost protection function
- Function for manual interruption of automatic functions already triggered
- additional connection for external temperature sensor
- Temperature measurement via internal, external temperature sensor or via object and their mean value formation
- Temperature adjustable for comfort, standby and night-time reduction
- operation via sensitive Touch control surface
- to display and initiate actions
- display of operating mode, controller lockout, room/outside temperature, time
- screen-savers
- TFT colour display with symbol display
- time and date display
- Menu guidance in DE/EN/FR/NL/IT/ES/PT/PL/DK/SV/FI/NO/TR
- with integrated bus coupling unit
- bus connection via connecting terminal
- with spreader claws



Suitable for	Order no.
Cover for KNX thermostats and room controllers	8096 01 ..
KNX power supply 2 x 320 mA + 24 V DC, 640 mA RMD	TXA114
Electrical power supply 24 V DC RMD	TGA200
<b>optional</b>	
KNX system package commissioning tool easy link RMD	TXA100
KNX Configuration server easy link RMD	TJA665
Temperature sensor	EK090

Design	Order no.	PU
KNX room controller	<b>8066 01 00</b>	1

## Cover for KNX thermostats and room controllers

Suitable for	Order no.
KNX thermostat	8044 01 00
KNX room controller	8066 01 00

Design	Order no.	PU
<b>Berker S.1/B.3/B.7</b>		
white glossy	<b>8096 01 82</b>	1
polar white glossy	<b>8096 01 89</b>	1
polar white, matt, plastic	<b>8096 01 80</b>	1
anthracite, matt	<b>8096 01 85</b>	1
aluminium matt, lacquered	<b>8096 01 83</b>	1



**Touch Panel**



**Touch Panel 7" Android**

Power over Ethernet (PoE)	18 ... 48 V=
Auxiliary voltage	18 ... 48 V=
Power consumption	< 10 W
TFT screen size	7"
Light intensity	300 cd/m <sup>2</sup>
Transmission rate Ethernet	max. 10/100 Mbit/s
Processor	1 GHz
RAM	512 MB
Operating temperature	+ 5 ... + 45 °C
Dimensions (W x H x D)	189.7 x 125.7 x 48.3 mm
Assembling height	12 mm

PoE power supply according to IEEE 802.3af Class 3 possible without audio applications.

- for display of preconfigured functions, measured values and data
- suitable for vertical and horizontal domovea visualisation
- depending on the software visualisation one and two surface operation, stepless configuration based on sliding and page scrolling by swiping are supported
- multi-touch function for the connection of multiple actions, e.g. to activate a function with simultaneous setting of a function value
- Display illumination can be switched on automatically using brightness sensor
- Connection to KNX system possible via a local server e.g. the domovea server
- external applications (Apps) available in pre-installed Android launcher
- Integration of door communication functions in the domovea client or Elcom VideoFON client
- silent, long-lasting convection cooling without fan
- RJ45 Port for LAN connection
- card slot with 8 GB SDHC card
- Microphone and loudspeaker with echo suppression
- with USB/Mini USB type A adapter cable
- with RJ45 connector kit from connector and patch cable
- Mini-USB 2.0 jack e.g. for external storage media or updates on the upper display edge is accessible without dismantling
- 2 USB 2.0 connections on the rear
- for flush mounting and hollow-wall mounting
- for vertical and horizontal mounting

<b>Suitable for</b>	<b>Order no.</b>
Housing flush-mounted for WDI07x	WDW070
Housing flush-mounted for WDI07x, flush-to-wall	WDW071
<b>optional</b>	
Electrical power supply 24 V DC RMD	TGA200
domovea Server incl. software RMD	TJA450
domovea system package RMD	TJA451

Design	Order no.	PU
anthracite, 7"	<b>WDI070</b>	1



**Touch Panel 10" Android**

Power over Ethernet (PoE)	18 ... 48 V=
Auxiliary voltage	18 ... 48 V=
Power consumption	< 10 W
TFT screen size	10"
Light intensity	300 cd/m <sup>2</sup>
Transmission rate Ethernet	max. 10/100 Mbit/s
Processor	1 GHz
RAM	512 MB
Operating temperature	+ 5 ... + 45 °C
Dimensions (W x H x D)	259.4 x 177 x 67.5 mm
Assembling height	10 mm

PoE power supply according to IEEE 802.3af Class 3 possible without audio applications.

- for display of preconfigured functions, measured values and data
- suitable for horizontal domovea visualisation
- depending on the software visualisation one and two surface operation, stepless configuration based on sliding and page scrolling by swiping are supported
- multi-touch function for the connection of multiple actions, e.g. to activate a function with simultaneous setting of a function value
- Display illumination can be switched on automatically using brightness sensor
- Connection to KNX system possible via a local server e.g. the domovea server
- external applications (Apps) available in pre-installed Android launcher
- Integration of door communication functions in the domovea client or Elcom VideoFON client
- silent, long-lasting convection cooling without fan
- RJ45 Port for LAN connection
- card slot with 8 GB SDHC card
- Microphone and loudspeaker with echo suppression
- with USB/Mini USB type A adapter cable
- with RJ45 connector kit from connector and patch cable
- Mini-USB 2.0 jack e.g. for external storage media or updates on the upper display edge is accessible without dismantling
- 2 USB 2.0 connections on the rear
- for flush mounting and hollow-wall mounting
- for horizontal mounting



Suitable for	Order no.
Housing flush-mounted for WDI10x	WDW100
Housing flush-mounted for WDI10x, flush-to-wall	WDW101
<b>optional</b>	
Electrical power supply 24 V DC RMD	TGA200
domovea Server incl. software RMD	TJA450
domovea system package RMD	TJA451

Design	Order no.	PU
anthracite, 10"	<b>WDI100</b>	1



**Touch Panel 10" Windows**

Auxiliary voltage	24 V=
Power consumption	max. 20 W
TFT screen size	10"
Light intensity	300 cd/m <sup>2</sup>
Transmission rate Ethernet	max. 1000 Mbit/s
Processor	2 x 1 GHz
RAM	2 GB
Operating temperature	+ 5 ... + 35 °C
Dimensions (W x H x D)	259.4 x 177 x 67.5 mm
Assembling height	10 mm

PoE power supply according to IEEE 802.3af Class 3 possible without audio applications.

- for display of preconfigured functions, measured values and data
- signal and operating panel with touch-sensitive TFT colour display in 16:9 format
- suitable for horizontal domovea visualisation
- depending on the software visualisation one and two surface operation, stepless configuration based on sliding and page scrolling by swiping are supported
- multi-touch function for the connection of multiple actions, e.g. to activate a function with simultaneous setting of a function value
- disabling function for cleaning the user interface
- Display illumination can be switched on automatically using brightness sensor
- Connection to KNX system possible via a local server e.g. the domovea server
- Visualisation for Berker IP-Control via browser
- integrated PC with Windows embedded operating system
- Integration of door communication functions in the Elcom VideoFON client
- silent, long-lasting convection cooling without fan
- 2 RJ45 Ports for LAN connection
- internal memory of 64 GB SSD present
- Microphone and loudspeaker with echo suppression
- with USB/Mini USB type A adapter cable
- with RJ45 connector kit from connector and patch cable
- Mini-USB 2.0 jack e.g. for external storage media or updates on the upper display edge is accessible without dismantling
- 2 USB 2.0 connections on the rear
- additional connection for Serial RS232
- RJ45 cable in scope of delivery
- for flush mounting and hollow-wall mounting
- for horizontal mounting

<b>Suitable for</b>	<b>Order no.</b>
Housing flush-mounted for WDI10x	WDW100
Housing flush-mounted for WDI10x, flush-to-wall	WDW101
<b>optional</b>	
Electrical power supply 24 V DC RMD	TGA200
domovea Server incl. software RMD	TJA450
domovea system package RMD	TJA451

Design	Order no.	PU
anthracite, 10"	<b>WDI101</b>	<b>1</b>

## Touch Panel 16" Windows

Auxiliary voltage	24 V=
Power consumption	max. 20 W
TFT screen size	16"
Light intensity	220 cd/m <sup>2</sup>
Transmission rate Ethernet	max. 1000 Mbit/s
Processor	2 x 1 GHz
RAM	2 GB
Operating temperature	+ 5 ... + 35 °C
Dimensions (W x H x D)	377.4 x 231.8 x 66.4 mm
Assembling height	11 mm

PoE power supply according to IEEE 802.3af Class 3 possible without audio applications.

- for display of preconfigured functions, measured values and data
- signal and operating panel with touch-sensitive TFT colour display in 16:9 format
- suitable for horizontal domovea visualisation
- depending on the software visualisation one and two surface operation, stepless configuration based on sliding and page scrolling by swiping are supported
- multi-touch function for the connection of multiple actions, e.g. to activate a function with simultaneous setting of a function value
- disabling function for cleaning the user interface
- Display illumination can be switched on automatically using brightness sensor
- Connection to KNX system possible via a local server e.g. the domovea server
- Visualisation for Berker IP-Control via browser
- integrated PC with Windows embedded operating system
- Integration of door communication functions in the Elcom VideoFON client
- silent, long-lasting convection cooling without fan
- 2 RJ45 Ports for LAN connection
- internal memory of 32 GB SSD present
- Microphone and loudspeaker with echo suppression
- with USB/Mini USB type A adapter cable
- with RJ45 connector kit from connector and patch cable
- Mini-USB 2.0 jack e.g. for external storage media or updates on the upper display edge is accessible without dismantling
- 2 USB 2.0 connections on the rear
- additional connection for Serial RS232
- RJ45 cable in scope of delivery
- for flush mounting and hollow-wall mounting
- for horizontal mounting



Suitable for	Order no.
Housing flush-mounted for WDI16x	WDW160
Housing flush-mounted for WDI16x, flush-to-wall	WDW161
<b>optional</b>	
Electrical power supply 24 V DC RMD	TGA200
domovea Server incl. software RMD	TJA450
domovea system package RMD	TJA451

Design	Order no.	PU
anthracite, 16"	<b>WDI161</b>	1

## Flush-mounted housing

- for installation of a Touch Panel
- with cleaning cover
- for flush mounting and hollow-wall mounting
- for vertical and horizontal mounting



Design	Order no.	PU
Housing flush-mounted for WDI07x, anthracite, lacquered <sup>1)</sup>	<b>WDW070</b>	1
Housing flush-mounted for WDI10x, anthracite, lacquered <sup>2)</sup>	<b>WDW100</b>	1
Housing flush-mounted for WDI16x, anthracite, lacquered <sup>3)</sup>	<b>WDW160</b>	1

<sup>1)</sup> Dimensions (W x H x D): 190 x 126 x 47 mm, cavity wall opening (W x H x D): 182 x 117 x 47 mm

<sup>2)</sup> Dimensions (W x H x D): 260 x 177 x 64 mm, cavity wall opening (W x H x D): 252 x 169 x 64 mm

<sup>3)</sup> Dimensions (W x H x D): 378 x 233 x 64 mm, cavity wall opening (W x H x D): 370 x 225 x 64 mm



**Flush-mounted housing, flush-to-wall**

- for flush-to-wall installation of a Touch Panel
- with Push-to-open mechanism for comfortable mounting
- with cleaning cover
- for flush mounting and hollow-wall mounting
- for vertical and horizontal mounting

Design	Order no.	PU
Housing flush-mounted for WDI07x, flush-to-wall, anthracite, lacquered <sup>1)</sup>	<b>WDW071</b>	1
Housing flush-mounted for WDI10x, flush-to-wall, anthracite, lacquered <sup>2)</sup>	<b>WDW101</b>	1
Housing flush-mounted for WDI16x, flush-to-wall, anthracite, lacquered <sup>3)</sup>	<b>WDW161</b>	1

<sup>1)</sup> Dimensions (W x H x D): 197.7 x 133.6 x 74 mm, cavity wall opening (W x H x D): 197.7 x 133.6 x 74 mm  
<sup>2)</sup> Dimensions (W x H x D): 269 x 186 x 74 mm, cavity wall opening (W x H x D): 269 x 186 x 74 mm  
<sup>3)</sup> Dimensions (W x H x D): 387 x 242 x 74 mm, cavity wall opening (W x H x D): 387 x 242 x 74 mm

**domovea**



**domovea Server incl. software RMD**

Operating voltage over bus	21 ... 32 V=
Auxiliary voltage	24 V=
Current consumption (operation)	≈ 150 mA
Power consumption (operation)	≈ 1.5 W
RAM	128 MB
Graphics memory	≈ 20 MB
Processor	400 MHz
Width of rail mounted device (RMD)	6 modules

Central operating and visualisation unit for KNX installations via client software.

- for control and visualisation of e.g. shutters, lights, heating, ventilation, alarm system, sensors
- creation of max. 50 sequences from different actions
- user interface can be configured individually for each room with special background images
- KNX server to supply up to 30 visualisation clients simultaneously with KNX data
- configuration tool for installation of IP settings and parameterisations
- with configuration and client software on USB stick
- with status LEDs for LAN status, operational stand-by and connection status to web portal
- creation of light scenes
- creation of measured value archives and energy consumption visualisation with KNX energy meters
- managing up to 30 users with different access rights
- software update via USB interface on the device
- integration of max. 10 network cameras
- RJ45 Port for LAN connection
- bus connection via connecting terminal
- with RJ45 connection for Ethernet/IP networks
- with QuickConnect plug-in terminals
- Large labelling field
- Selection switcandroidh for online/offline mode
- with integrated bus coupling unit

<b>Suitable for</b>	<b>Order no.</b>
Electrical power supply 24 V DC RMD	TGA200 ..
Touch Panel 10" Android	WDI1 ..
Touch Panel 7" Android	WDI070 ..

**Manufacturer product line** **Art. No.**  
**KNX energy meters**  
Hager

Design	Order no.	PU
Light grey matt	<b>TJA450</b>	1

## domovea basic with easy and IoT

Powered via bus via bus	21–32 V DC
Auxiliary voltage	24 V DC
Ethernet data rate	Max. 2 x 100/1000 Mbit / s
Operating temperature	- 5 ... 45 ° C
Conductor cross-section (flexible)	0.75 ... 2.5 mm <sup>2</sup>
Conductor cross-section (fixed)	0.75 ... 2.5 mm <sup>2</sup>
Width of rail mounted device (RMD)	6 Modules

- with integrated basic domovea
- Integration of IoT applications (Amazon Echo, Sonos, Phillips Hue, Netatmo weather station Google Home, IFTTT) possible
- Selector for online / offline operation
- Integration of two IP cameras

- with green and red status LEDs for LAN status, operational readiness, KNX status and gateway connection
- Voltage supply via PoE or 24 VDC
- 2 RJ45 ports for LAN connection
- with 2 USB sockets, type B, USB 2.0 compliant
- With label area
- with integrated bus coupler
- Bus connection via connecting terminal
- Quick Connect plug-in terminals
- Knowledge of network technology is required for commissioning
- System Requirements: Windows 7, Android 6, ios 11.



Design	Order no.	PU
domovea basic with easy and IoT	<b>TJA670</b>	1

## domovea expert with easy and IoT

Powered via bus via bus	21–32 V DC
Auxiliary voltage	24 V DC
Ethernet data rate	Max. 2 x 100/1000 Mbit / s
Operating temperature	- 5 ... 45 ° C
Conductor cross-section (flexible)	0.75 ... 2.5 mm <sup>2</sup>
Conductor cross-section (fixed)	0.75 ... 2.5 mm <sup>2</sup>
Width of rail mounted device (RMD)	6 Modules

- with integrated basic domovea
- Integration of IoT applications (Amazon Echo, Sonos, Phillips Hue, Netatmo weather station Google Home, IFTTT) possible
- Selector for online / offline operation
- Integration of 50 IP cameras

- Advanced sequences
- Local and remote access
- Thermostat regulation
- with green and red status LEDs for LAN status, operational readiness, KNX status and gateway connection
- Voltage supply via PoE or 24 VDC
- 2 RJ45 ports for LAN connection
- with 2 USB sockets, type B, USB 2.0 compliant
- With label area
- with integrated bus coupler
- Bus connection via connecting terminal
- Quick Connect plug-in terminals
- Knowledge of network technology is required for commissioning
- System Requirements: Windows 7, Android 6, ios 11.



Design	Order no.	PU
domovea expert with easy and IoT	<b>TJA470</b>	1

## KNX motion detector

- The configuration server (order no.: TJA665) or the tool set (order no.: TXA100) is required for easy commissioning via easy link.

### KNX motion detector module 1.1 m

- internal temperature sensor
- integrated bus coupling unit

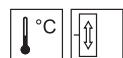

Operating voltage over bus	21 ... 32 V=
Current consumption KNX	max. 10 mA
Nominal mounting height	1.1 m
Delay time, adjustable	10 s ... 30 min
Response brightness, adjustable	≈ 5 ... 1000 lx, ∞ lx (day)
Detection angle, settable	each side ≈ 45 ... 90 °
Detection field, rectangular shaped	≈ 12 x 16 m
Operating temperature	- 5 ... + 45 ° C

Automatic triggering of bus functions for movement within the detection area or manual control via integrated button.

Continuous direct sunlight penetrating the upward-pointing detection plane can result in failure of the motion detector.  
Only suitable for indoor areas!

- with 3 operating modes: automatic/permanent ON/permanent OFF
- Master/Slave operation for covering large detection areas
- with test mode
- with button for automatic/permanent ON/permanent OFF
- Operating mode display via status LED, red/green/orange
- two function channels for brightness-dependent functions
- additional channel for independent of brightness detector mode
- Output of the brightness value via object possible
- with integrated bus coupling unit
- bus connection via connecting terminal
- with dismantling protection

<b>Suitable for</b>	<b>Order no.</b>
Cover for KNX motion detector module	8096 04 ..
<b>optional</b>	
KNX Configuration server easy link RMD	TJA665
KNX system package commissioning tool easy link RMD	TXA100

Design	Order no.	PU
<b>Berker S.1/B.3/B.7</b>		
KNX motion detector module 1.1 m	<b>8026 21 80</b>	1



**KNX motion detector module 2.2 m**

- internal temperature sensor
- integrated bus coupling unit

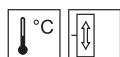

Operating voltage over bus	21 ... 32 V=
Current consumption KNX	max. 10 mA
Nominal mounting height	2.2 m
Delay time, adjustable	10 s ... 30 min
Response brightness, adjustable	≈ 5 ... 1000 lx, ∞ lx (day)
Detection angle, settable	each side ≈ 45 ... 90 °
Detection field, rectangular shaped	≈ 8 x 12 m
Operating temperature	- 5 ... + 45 °C

Automatic triggering of bus functions for movement within the detection area or manual control via integrated button.

Continuous direct sunlight penetrating the upward-pointing detection plane can result in failure of the motion detector.  
Only suitable for indoor areas!

- with 3 operating modes: automatic/permanent ON/permanent OFF
- Master/Slave operation for covering large detection areas
- with test mode
- with button for automatic/permanent ON/permanent OFF
- Operating mode display via status LED, red/green/orange
- two function channels for brightness-dependent functions
- additional channel for independent of brightness detector mode
- Output of the brightness value via object possible
- with integrated bus coupling unit
- bus connection via connecting terminal
- with dismantling protection

<b>Suitable for</b>	<b>Order no.</b>
Cover for KNX motion detector module	8096 04 ..
<b>optional</b>	
KNX Configuration server easy link RMD	TJA665
KNX system package commissioning tool easy link RMD	TXA100

Available from 01/2016

Design	Order no.	PU
<b>Berker S.1/B.3/B.7</b>		
KNX motion detector module 2.2 m	<b>8026 22 80</b>	<b>1</b>



**Cover for KNX motion detector module**

Available from 01/2016

<b>Suitable for</b>	<b>Order no.</b>
KNX motion detector module 1.1 m	8026 21 ..
KNX motion detector module 2.2 m	8026 22 ..

Design	Order no.	PU
<b>Berker S.1/B.3/B.7</b>		
white glossy	<b>8096 04 52</b>	<b>1</b>
polar white glossy	<b>8096 04 59</b>	<b>1</b>
anthracite, matt	<b>8096 04 85</b>	<b>1</b>
aluminium, matt, lacquered	<b>8096 04 83</b>	<b>1</b>

**Presence detectors**

**KNX presence detector with constant light control**

Operating voltage over bus	21 ... 32 V=	– with potentiometers for setting the response brightness and delay time without dismantling
Current consumption	12 mA	– energy saving by presence and brightness-controlled lighting control
Recommended installation height	≈ 2.5 ... 3.5 m	– bus connection via connecting terminal
Brightness measuring range	5 ... 1200 lx	– with constant light control
Delay time, adjustable	1 min ... 30 min	
Detection angle	360 °	
Operating temperature	+ 0 ... + 45 °C	
Dimensions (Ø x H)	110 x 44 mm	



	<b>Suitable for optional</b>	<b>Order no.</b>
	KNX Configuration server easy link RMD	TJA6 65 ..
	KNX system package commissioning tool easy link RMD	TXA1 00 ..
	Surface-mounted housing for presence detector	EE8 13
Design	Order no.	PU
white	<b>TXC511</b>	1

**Surface-mounted housing for presence detector**

Dimensions (Ø x H)	70 x 45 mm	– with cable entry
	<b>Suitable for</b>	<b>Order no.</b>
	KNX presence detector with constant light control	TXC511
		<b>Page 45</b>



Design	Order no.	PU
polar white matt	<b>EE813</b>	1

**IR presence detectors**

– The configuration server (order no.: TJA665) or the tool set (order no.: TXA100) is required for easy commissioning via easy link.

**KNX IR presence detector**

Operating voltage over bus	21 ... 32 V=	– energy saving by presence and brightness-controlled lighting control
Recommended installation height	≈ 2.5 ... 3.5 m	– linking several detectors in order to expand the detection range
Brightness measuring range	5 ... 1000 lx	– with integrated bus coupling unit
Delay time, adjustable	≈ 1 min ... 1 h	– with potentiometers for setting the response brightness and delay time without dismantling
Detection angle	360 °	– with programming button
Detection field Ø, on floor	≈ 7 m	– bus connection via connecting terminal
Detection field Ø, at desk height	≈ 5 m	– with spring clips for ceiling installation
Operating temperature	- 10 ... + 45 °C	
Installation opening Ø	60 ... 63 mm	
Dimensions (Ø x H)	78 x 70 mm	



	<b>Suitable for optional</b>	<b>Order no.</b>
	KNX Configuration server easy link RMD	TJA665
	KNX system package commissioning tool easy link RMD	TXA100
	IR configuration hand-held transmitter for presence detector	EE807
	IR hand-held transmitter for presence detector	EE808
	Surface-mounted housing for presence detector	EEK005
Design	Order no.	PU
polar white matt	<b>TCC510S</b>	1





**Surface-mounted housing for presence detector**

Dimensions (Ø x H) 75 x 65 mm

– with cable entry

Suitable for  
KNX IR presence detector

Order no.  
TCC510S

Design  
polar white, matt, plastic

Order no.  
**EEK005**

PU  
**1**



**IR hand-held transmitter for presence detector**

Battery service life [years] ≈ 3.5  
Dimensions (L x W x H) 120 x 70 x 10 mm

– with 4 function buttons (calling up/saving light scene)  
– with green "on" and red "off" button (on/off, dimmer function)  
– additional acknowledgement LED for displaying the IR transmission  
– RC6 code

For control for the lighting connected to the presence detector.  
Scope of functions dependent on the controlled presence detector.  
Required battery (CR 2032) is included in the scope of delivery.

Suitable for  
KNX IR presence detector

Order no.  
TCC510S

Design  
black matt

Order no.  
**EE808**

PU  
**1**



**IR configuration hand-held transmitter for presence detector**

Battery service life [years] ≈ 2.5  
Dimensions (L x W x H) 111 x 63 x 10 mm

– 15 buttons with integrated status-LED  
– additional acknowledgement LED for displaying the IR transmission  
– 3 configuration ranges for control, switch-off delay, brightness threshold  
– setting of the brightness threshold manually, by default values or teach-in mode  
– default settings can be selected for the brightness threshold daylight, office, corridor  
RC6 code  
– 2 configuration memories for identical configuration of several presence detectors

For convenient configuration of supported presence detectors.  
Required battery (CR 2032) is included in the scope of delivery.

Suitable for  
KNX IR presence detector

Order no.  
TCC510S

Design  
black matt

Order no.  
**EE807**

PU  
**1**

**Twilight switch RMD**

– The configuration server (order no.: TJA665) or the tool set (order no.: TXA100) is required for easy commissioning via easy link.



**Twilight switch 6 channel RMD**

Operating voltage over bus 21 ... 32 V=  
Operating temperature + 0 ... + 45 °C  
Line length max. 100 m  
Conductor cross-section (flexible) 1 ... 6 mm<sup>2</sup>  
Conductor cross-section (rigid) 1 ... 10 mm<sup>2</sup>  
Width of rail mounted device (RMD) 2 modules

– for switch, dimmer and shutter functions  
– manual operation can be activated via selection switch, thereby deactivation of the KNX function  
– Brightness modifiable via potentiometer  
– six brightness limit values for independent activation of switching channels  
– with 2 status LEDs  
– with programming button and red programming LED  
– with integrated bus coupling unit  
– bus connection via connecting terminal  
– with screw terminals

Suitable for  
Brightness sensor built-in  
Brightness sensor surface-mounted  
**optional**  
KNX Configuration server easy link RMD  
KNX system package commissioning tool easy link RMD

Order no.  
EE002  
EE003  
TJA665 ..  
TXA100 ..

Design  
light grey

Order no.  
**TXA025**

PU  
**1**



**Twilight switch 6 channel RMD with brightness sensor RMD**

Operating voltage over bus	21 ... 32 V=
Operating temperature	+ 0 ... + 45 °C
Line length	max. 100 m
Conductor cross-section (flexible)	1 ... 6 mm <sup>2</sup>
Conductor cross-section (rigid)	1.5 ... 10 mm <sup>2</sup>
Width of rail mounted device (RMD)	2 modules

- six brightness limit values for independent activation of switching channels
- with surface-mounted brightness sensor IP65
- with programming button and red programming LED
- with integrated bus coupling unit
- with screw terminals



<b>Suitable for optional</b>	<b>Order no.</b>
KNX Configuration server easy link RMD	TJA665 ..
KNX system package commissioning tool easy link RMD	TXA100 ..
Brightness sensor built-in replacement	EE002
Brightness sensor surface-mounted	EE003

Design	Order no.	PU
Twilight switch 6 channel RMD with brightness sensor RMD	<b>TXA026</b>	1

**Brightness sensor built-in**

Pre-assembled cables	≈ 1 m
To detect ambient brightness.	

<b>Suitable for</b>	<b>Order no.</b>
Twilight switch 6 channel RMD with brightness sensor RMD	TXA026
Twilight switch 6 channel RMD	TXA025



Design	Order no.	PU
Brightness sensor built-in	<b>EE002</b>	1

**Brightness sensor surface-mounted**

Conductor cross-section (flexible)	0.75 ... 4 mm <sup>2</sup>
To detect ambient brightness.	

<b>Suitable for</b>	<b>Order no.</b>
Twilight switch 6 channel RMD	TXA025
Twilight switch 6 channel RMD with brightness sensor RMD	TXA026



Design	Order no.	PU
Brightness sensor surface-mounted	<b>EE003</b>	1

Physical sensors

- The configuration server (order no.: TJA665) or the tool set (order no.: TXA100) is required for easy commissioning via easy link.



**Weather station with GPS surface-mounted**

Operating voltage over bus	21 ... 32 V=
Auxiliary voltage	24 V~/=
Rated current (heating incl.)	81 mA
Brightness measuring range	0 ... 150000 lx
Temperature measuring range, linear	- 30 ... + 80 °C
Measuring range, wind speed	0 ... 35 m/s
Precipitation (Yes/No)	1 bit
Operating temperature	- 30 ... + 50 °C
Dimensions (W x H x D)	96 x 77 x 118 mm
Weight	≈ 170 g

For detection of wind, precipitation, temperature and brightness as well to process the signals.  
Ensure correct orientation and free-standing installation.

- With wind, precipitation, twilight, temperature and brightness sensor
- with automatic summer/winter time change-over
- with heater element for winter operation
- with red programming LED
- for control of shading systems for up to 4 facades
- easy commissioning by means of predefined parameters
- predefined parameters when activating heat protection function or heat recovery function
- Periodical emission for outside temperature, frost alarm, brightness, day/night mode, wind alarms and rain alarm predefined
- Three preset limit values for wind alarm
- bus connection via connecting terminal
- with plug-in terminals for power supply
- for wall and mast assembly
- with pipe clamp for mast fixing

Suitable for optional	Order no.
KNX Configuration server easy link RMD	TJA665
KNX system package commissioning tool easy link RMD	TXA100
KNX power supply 2 x 320 mA + 24 V DC, 640 mA RMD	TXA114
Electrical power supply 24 V DC RMD	TGA200

Design	Order no.	PU
white transparent	<b>TXE531</b>	1



**Temperature sensor**

Characteristic resistance value at 25 °C	10 kΩ
Operating temperature	- 40 ... + 80 °C
Sensor cable length	4 m

- as replacement or function extension of products with suitable connection, such as thermostat, glass sensors or KNX thermostat

Suitable for	Order no.
Push-button module 1gang	8014 11 ..
Push-button module 2gang	8014 21 ..
KNX thermostat	8044 01 00
KNX room controller	8066 01 00
Bus application unit flush-mounted	8004 00 ..



Design	Order no.	PU
Temperature sensor	<b>EK090</b>	1

**Timers**

– The configuration server (order no.: TJA665) or the tool set (order no.: TXA100) is required for easy commissioning via easy link.

**Week time switch 2gang RMD**

Operating voltage over bus	21 ... 32 V=	– functions e.g. switching, dimming, blinds, light scenes, heating, operating modes, date, time
Lithium cell power reserve [years]	≈ 5	– with 5 manual operation buttons
Operating temperature	+ 0 ... + 45 °C	– with programming button and red programming LED
Conductor cross-section (flexible)	1.5 ... 10 mm <sup>2</sup>	– with programming key
Conductor cross-section (rigid)	1 ... 6 mm <sup>2</sup>	– with integrated bus coupling unit
Width of rail mounted device (RMD)	2 modules	– bus connection via connecting terminal
		– with screw terminal



<b>Suitable for</b>	<b>Order no.</b>
Programming key for time switches	EG005
Blocking key for time switches	EG004
<b>optional</b>	
KNX Configuration server easy link RMD	TJA665
KNX system package commissioning tool easy link RMD	TXA100

Design	Order no.	PU
Week time switch 2gang RMD	<b>TXA022</b>	1

**Blocking key for time switches**

Operating temperature	- 5 ... + 45 °C	<b>Suitable for</b>	<b>Order no.</b>
Dimensions (L x W x H)	10 x 20 x 30 mm	Week time switch 2gang RMD	TXA02 ..
		<b>optional</b>	
		Storage tray for programming keys	EG006



Design	Order no.	PU
Blocking key for time switches	<b>EG004</b>	1



**Programming key for time switches**

Operating temperature - 5 ... + 45 °C  
 Dimensions (L x W x H) 10 x 20 x 30 mm

**Suitable for**  
 Week time switch 2gang RMD  
**optional**  
 Storage tray for programming keys

**Order no.**  
 TXA02 ..  
 EG006

Design	Order no.	PU
Programming key for time switches	<b>EG005</b>	1



**USB key adapter with software**

Operating temperature + 0 ... + 40 °C

Design	Order no.	PU
USB key adapter with software	<b>EG003G</b>	1

**Universal interfaces**

– The configuration server (order no.: TJA665) or the tool set (order no.: TXA100) is required for easy commissioning via easy link.



**Universal interface 2gang flush-mounted**

Operating voltage over bus 21 ... 32 V=  
 Input scanning voltage per channel 5 V  
 Operating temperature + 0 ... + 45 °C  
 Line length max. 5 m  
 Dimensions (L x W x H) 38 x 35 x 12 mm

- Switching functions, dimming functions, blind control functions, value transmitter functions, forced control functions, scene functions, heating functions and timer functions, 2 channel mode
- with programming button and red programming LED
- with 2 independent binary inputs for potential-free contacts
- with integrated bus coupling unit
- bus connection via connecting terminal
- for flush mounting and hollow-wall mounting

For connection of potential-free contacts, e.g. switches, push-buttons, window contacts, detector contacts or thermostats, for communication into KNX bus system.

**Suitable for**  
**optional**  
 KNX Configuration server easy link RMD  
 KNX system package commissioning tool easy link RMD

**Order no.**  
 TJA665 ..  
 TXA100 ..

Design	Order no.	PU
Universal interface 2gang flush-mounted	<b>TXB302</b>	1

### Universal interface 2gang with 2 LED outputs flush-mounted

Operating voltage over bus	21 ... 32 V=
Input scanning voltage	per channel 5 V
Operating temperature	+ 0 ... + 45 °C
Line length	max. 5 m
Dimensions (L x W x H)	38 x 35 x 12 mm

For connection of potential-free contacts, e.g. switches, push-buttons, window contacts, detector contacts or thermostats, for communication into KNX bus system.

- Switching functions, dimming functions, blind control functions, value transmitter functions, forced control functions, scene functions and heating functions, 2 channel mode
- with programming button and red programming LED
- with 2 independent binary inputs for potential-free contacts
- with 2 freely parameterisable outputs for LED activation
- with integrated bus coupling unit
- bus connection via connecting terminal
- for flush mounting and hollow-wall mounting



Suitable for optional	Order no.
KNX Configuration server easy link RMD	TJA665 ..
KNX system package commissioning tool easy link RMD	TXA100 ..

Design	Order no.	PU
Universal interface 2gang with 2 LED outputs flush-mounted	<b>TXB322</b>	1

### Universal interface 4gang flush-mounted

Operating voltage over bus	21 ... 32 V=
Input scanning voltage	per channel 5 V
Operating temperature	+ 0 ... + 45 °C
Line length	max. 5 m
Dimensions (L x W x H)	38 x 35 x 12 mm

For connection of potential-free contacts, e.g. switches, push-buttons, window contacts, detector contacts or thermostats, for communication into KNX bus system.

- Switching functions, dimming functions, blind control functions, value transmitter functions, forced control functions, scene functions, heating functions and timer functions, 2 channel mode
- with programming button and red programming LED
- with 4 independent binary inputs for potential-free contacts
- with integrated bus coupling unit
- bus connection via connecting terminal
- for flush mounting and hollow-wall mounting



Suitable for optional	Order no.
KNX Configuration server easy link RMD	TJA665 ..
KNX system package commissioning tool easy link RMD	TXA100 ..

Design	Order no.	PU
Universal interface 4gang flush-mounted	<b>TXB304</b>	1

### Universal interface 4gang with 4 LED outputs, flush-mounted

Operating voltage over bus	21 ... 32 V=
Input scanning voltage	per channel 5 V
Operating temperature	+ 0 ... + 45 °C
Line length	max. 5 m
Dimensions (L x W x H)	38 x 35 x 12 mm

For connection of potential-free contacts, e.g. switches, push-buttons, window contacts, detector contacts or thermostats, for communication into KNX bus system.

- Switching functions, dimming functions, blind control functions, value transmitter functions, forced control functions, scene functions and heating functions, 2 channel mode
- with programming button and red programming LED
- with 4 independent binary inputs for potential-free contacts
- with 4 freely configurable outputs for LED activation
- with integrated bus coupling unit
- bus connection via connecting terminal
- for flush mounting and hollow-wall mounting



Suitable for optional	Order no.
KNX Configuration server easy link RMD	TJA665 ..
KNX system package commissioning tool easy link RMD	TXA100 ..

Design	Order no.	PU
light grey	<b>TXB344</b>	1

**Binary inputs**

– The configuration server (order no.: TJA665) or the tool set (order no.: TXA100) is required for easy commissioning via easy link.



**Binary input 230 V AC RMD**

Operating voltage over bus	21 ... 32 V=
Input voltage	230 V~
Signal frequency	50/60 Hz
Input cable length	max. 100 m
Operating temperature	+ 0 ... + 45 °C
Conductor cross-section (rigid)	0.75 ... 2.5 mm <sup>2</sup>
Conductor cross-section (flexible)	0.75 ... 2.5 mm <sup>2</sup>

For connection of 230 V AC power supplied contacts for communication into KNX bus system.

- Switching functions, dimming functions, blind control functions, value transmitter functions, forced control functions, scene functions, heating functions and timer functions, 2 channel mode
- with programming button and red programming LED
- manual operation per channel via button with integrated status LED, thereby lockout of KNX function
- manual operation can be activated via selection switch
- with integrated bus coupling unit
- bus connection via connecting terminal
- suitable for different external conductors
- with QuickConnect plug-in terminals

<b>Suitable for optional</b>	<b>Order no.</b>
KNX Configuration server easy link RMD	TJA665 ..
KNX system package commissioning tool easy link RMD	TXA100 ..

Design	Order no.	PU
<b>4 independent binary inputs with separate neutral conductor</b>		
4gang <sup>1)</sup>	<b>TXA304</b>	<b>1</b>
<b>10 independent binary inputs with separate neutral conductor</b>		
10gang <sup>2)</sup>	<b>TXA310</b>	<b>1</b>



<sup>1)</sup> Dimensions (W x H x D): 72 x 90 x 70 mm, 4 modules

<sup>2)</sup> Dimensions (W x H x D): 105 x 90 x 65 mm, 6 modules



**Binary input, 6gang, RMD, 24 V AC/DC - 230 V AC**

Operating voltage over bus	21 ... 32 V=
Signal voltage	potential-free, 24 ... 230 V~/=
Input cable length	max. 100 m
Operating temperature	+ 0 ... + 45 °C
Conductor cross-section (rigid)	0.75 ... 2.5 mm <sup>2</sup>
Conductor cross-section (flexible)	0.75 ... 2.5 mm <sup>2</sup>
Dimensions (W x H x D)	105 x 90 x 65 mm
Width of rail mounted device (RMD)	6 modules

For connection of potential-free or 230 ... 230 V AC/DC power supplied contacts for communication into KNX bus system.

- Switching functions, dimming functions, blind control functions, value transmitter functions, forced control functions, scene functions, heating functions and timer functions, 2 channel mode
- with 6 red status LEDs for display of input states
- with programming button and red programming LED
- manual operation per channel via button with integrated status LED, thereby lockout of KNX function
- manual operation can be activated via selection switch
- with integrated bus coupling unit
- bus connection via connecting terminal
- with 6 independent binary inputs with separate neutral conductor
- suitable for different external conductors
- with QuickConnect plug-in terminals

<b>Suitable for optional</b>	<b>Order no.</b>
KNX Configuration server easy link RMD	TJA665
KNX system package commissioning tool easy link RMD	TXA100

Design	Order no.	PU
6gang	<b>TXA306</b>	<b>1</b>

## KNX Actuators

### Switch actuators/blind actuators RMD easy

- The configuration server (order no.: TJA665) or the tool set (order no.: TXA100) is required for easy commissioning via easy link.

#### Switch actuator/blind actuator RMD, 10 A

Operating voltage over bus	21 ... 32 V=
Frequency	50/60 Hz
Switching current at cos φ = 0.8	max. 10 A
230 V LED lamps	12 x 23 W
Quantity LED lamps	per channel max. 12
Quantity energy-saving lamps	per channel max. 12
230 V incandescent lamps	1200 W
230 V halogen lamps	1200 W
Conventional transformers	1200 VA
Electronic transformers	1000 W
Fluorescent lamps:	
- with electronical ballast (EB)	15 x 36 W
Operating temperature	- 5 ... + 45 °C
Conductor cross-section (flexible)	0.75 ... 2.5 mm <sup>2</sup>
Conductor cross-section (rigid)	0.75 ... 2.5 mm <sup>2</sup>

- for switching of an independent load per actuator channel or activation of a blind drive via two actuator channels each
- any combined operation from drive and switching functions possible
- manual operation can be activated via 2-level selection switch, thereby deactivation of the KNX function
- with illuminated programming button
- with manual operation button for on/off (up/down) and bus function on/off per channel (single area operation)
- Status LED integrated in manual operation button
- with positioning function for shutter and blade position
- with safety functions e.g. for wind, rain, alarm
- with sun shade function
- with potential-free normally-open contact
- Large labelling field
- suitable to switch different external conductors
- with integrated bus coupling unit
- bus connection via connecting terminal
- with QuickConnect plug-in terminals



Follow the motor manufacturers' instructions.  
For switching of independent loads or activation of drives.

Suitable for optional	Order no.
KNX Configuration server easy link RMD	TJA665
KNX system package commissioning tool easy link RMD	TXA100

Design	Order no.	PU
<b>6 control channels/3 blind actuator channels</b>		
light grey, 6/3gang <sup>1)</sup>	<b>TXA606B</b>	1
<b>8 control channels/4 blind actuator channels</b>		
light grey, 8/4gang, with Auxiliary voltage <sup>2)</sup>	<b>TXA608B</b>	1
<b>10 control channels/5 blind actuator channels</b>		
light grey, 10/5gang <sup>2)</sup>	<b>TXA610B</b>	1



<sup>1)</sup> Dimensions (W x H x D): 70 x 90 x 65 mm, 4 modules

<sup>2)</sup> Dimensions (W x H x D): 105 x 90 x 65 mm, 6 modules



**Switch actuator/blind actuator RMD for C load, 16 A**

Operating voltage over bus	21 ... 32 V=
Frequency	50/60 Hz
Switching current at $\cos \phi = 0.8$	max. 16 A
230 V LED lamps	18 x 23 W
Quantity LED lamps	per channel max. 18
Quantity energy-saving lamps	per channel max. 18
230 V incandescent lamps	2300 W
230 V halogen lamps	2300 W
Electronic transformers	1200 W
Operating temperature	- 5 ... + 45 °C
Conductor cross-section (flexible)	0.75 ... 2.5 mm <sup>2</sup>
Conductor cross-section (rigid)	0.75 ... 2.5 mm <sup>2</sup>

- for switching of an independent load per actuator channel or activation of a blind drive via two actuator channels each
- any combined operation from drive and switching functions possible
- manual operation can be activated via 2-level selection switch, thereby deactivation of the KNX function
- with illuminated programming button
- with manual operation button for on/off (up/down) and bus function on/off per channel (single area operation)
- Status LED integrated in manual operation button
- with positioning function for shutter and blade position
- with safety functions e.g. for wind, rain, alarm
- with sun shade function
- with potential-free normally-open contact
- Large labelling field
- suitable to switch different external conductors
- with integrated bus coupling unit
- bus connection via connecting terminal
- with QuickConnect plug-in terminals

Follow the motor manufacturers' instructions.  
For switching of independent loads or activation of drives.

<b>Suitable for optional</b>	<b>Order no.</b>
KNX Configuration server easy link RMD	TJA665
KNX system package commissioning tool easy link RMD	TXA100

Design	Order no.	PU
<b>4 control channels/2 blind actuator channels</b>		
light grey, 4/2gang <sup>1)</sup>	<b>TXA604D</b>	<b>1</b>
<b>6 control channels/3 blind actuator channels</b>		
light grey, 6/3gang <sup>1)</sup>	<b>TXA606D</b>	<b>1</b>
<b>8 control channels/4 blind actuator channels</b>		
light grey, 8/4gang, with Auxiliary voltage <sup>2)</sup>	<b>TXA608D</b>	<b>1</b>
<b>10 control channels/5 blind actuator channels</b>		
light grey, 10/5gang <sup>2)</sup>	<b>TXA610D</b>	<b>1</b>



<sup>1)</sup> Dimensions (W x H x D): 70 x 90 x 65 mm, 4 modules  
<sup>2)</sup> Dimensions (W x H x D): 105 x 90 x 65 mm, 6 modules



## Switch actuator/blind actuator RMD for C load, 16 A

Operating voltage over bus	21 ... 32 V=
Frequency	50/60 Hz
Switching current at cos φ = 0.8	max. 16 A
230 V LED lamps	25 x 18 W
Quantity LED lamps	per channel max. 25
Quantity energy-saving lamps	per channel max. 25
230 V incandescent lamps	2300 W
230 V halogen lamps	2300 W
Conventional transformers	1500 VA
Electronic transformers	1500 W
Fluorescent lamps:	
- with electronical ballast (EB)	20 x 36 W
Operating temperature	- 5 ... + 45 °C
Conductor cross-section (flexible)	0.75 ... 2.5 mm <sup>2</sup>
Conductor cross-section (rigid)	0.75 ... 2.5 mm <sup>2</sup>

- for switching of an independent load per actuator channel or activation of a blind drive via two actuator channels each
- any combined operation from drive and switching functions possible
- manual operation can be activated via 2-level selection switch, thereby deactivation of the KNX function
- with illuminated programming button
- with manual operation button for on/off (up/down) and bus function on/off per channel (single area operation)
- Status LED integrated in manual operation button
- with positioning function for shutter and blade position
- with safety functions e.g. for wind, rain, alarm
- with sun shade function
- with potential-free normally-open contact
- Large labelling field
- suitable to switch different external conductors
- with integrated bus coupling unit
- bus connection via connecting terminal
- with screw terminals



Follow the motor manufacturers' instructions.  
For switching of independent loads or activation of drives.

Suitable for optional	Order no.
KNX Configuration server easy link RMD	TJA665
KNX system package commissioning tool easy link RMD	TXA100

Design	Order no.	PU
<b>16 control channels/8 blind actuator channels</b>		
light grey, 16/8gang <sup>1)</sup>	<b>TXM616D</b>	1
<b>20 control channels/10 blind actuator channels</b>		
light grey, 20/10gang <sup>2)</sup>	<b>TXM620D</b>	1



<sup>1)</sup> Dimensions (W x H x D): 140 x 90 x 65 mm, 8 modules  
<sup>2)</sup> Dimensions (W x H x D): 175 x 90 x 65 mm, 10 modules

Order no.

### Busbar for TXM616D

- TXM616D**
- Designed for TXM616
  - 2 pieces of 8 pin busbars
  - In 16A



TM616D

Order no.

### Busbar for TXM620D

- TGM620D**
- Designed for TXM620D
  - 2 pieces of 10 pin busbars
  - In 16A

Order no.

### End caps for TGM616D or TGM620D busbars

- TGM600E**
- Designed for TXM616D or TXM620D
  - 10 pairs of end caps

**Dim actuators RMD easy**

– The configuration server (order no.: TJA665) or the tool set (order no.: TXA100) is required for easy commissioning via easy link.



**Universal dim actuator 1gang RMD 300 W**

Operating voltage over bus	21 ... 32 V=
Auxiliary voltage	230 V~
Frequency	50/60 Hz
Dimmable 230 V LED lamps	60 W
Quantity of dimmable, 230 V LED lamps	max. 8
Dimmable energy-saving lamps	60 W
Quantity energy-saving lamps	max. 8
230 V incandescent lamps and halogen lamps	300 W
Dimmable conventional transformers	300 VA
Electronic transformers	300 W
Operating temperature	- 5 ... + 45 °C
Conductor cross-section (flexible)	0.75 ... 2.5 mm <sup>2</sup>
Conductor cross-section (rigid)	0.75 ... 2.5 mm <sup>2</sup>
Dimensions (W x H x D)	70 x 90 x 65 mm
Width of rail mounted device (RMD)	4 modules

Do not connect conventional transformers together with electronic transformers.

- selection switch for manual/bus operation as well as load setting
- manual operation can be activated via selection switch, thereby deactivation of the KNX function
- manual operation also possible without bus e.g. on building site
- manual operation per channel using button (single-area operation)
- Status LED integrated in manual operation button
- with illuminated programming button
- learning function for optimised operation of compact fluorescent lamps and LED luminaires can be activated via the bus
- specification of the load type per channel possible using button on the device
- phase cut-on or cut-off according to load type, self-learning
- minimum/maximum dimming values per channel settable on device
- Large labelling field
- short-circuit proof and overload proof (display per channel using LEDs)
- overheating protection (display using LEDs)
- with integrated bus coupling unit
- bus connection via connecting terminal
- with QuickConnect plug-in terminals

<b>Suitable for optional</b>	<b>Order no.</b>
KNX Configuration server easy link RMD	TJA665
KNX system package commissioning tool easy link RMD	TXA100

Design	Order no.	PU
light grey	<b>TXA661A</b>	1



**Universal dim actuator 1gang RMD 600 W**

Operating voltage over bus	21 ... 32 V=
Auxiliary voltage	230 V~
Frequency	50/60 Hz
Dimmable 230 V LED lamps	120 W
Quantity of dimmable, 230 V LED lamps	max. 10
Dimmable energy-saving lamps	120 W
Quantity energy-saving lamps	max. 8
230 V incandescent lamps and halogen lamps	600 W
Dimmable conventional transformers	600 VA
Electronic transformers	600 W
Operating temperature	- 5 ... + 45 °C
Conductor cross-section (flexible)	0.75 ... 2.5 mm <sup>2</sup>
Conductor cross-section (rigid)	0.75 ... 2.5 mm <sup>2</sup>
Dimensions (W x H x D)	70 x 90 x 65 mm
Width of rail mounted device (RMD)	4 modules

Do not connect conventional transformers together with electronic transformers.

- selection switch for manual/bus operation as well as load setting
- manual operation can be activated via selection switch, thereby deactivation of the KNX function
- manual operation also possible without bus e.g. on building site
- manual operation per channel using button (single-area operation)
- Status LED integrated in manual operation button
- with illuminated programming button
- learning function for optimised operation of compact fluorescent lamps and LED luminaires can be activated via the bus
- specification of the load type per channel possible using button on the device
- phase cut-on or cut-off according to load type, self-learning
- minimum/maximum dimming values per channel settable on device
- Large labelling field
- short-circuit proof and overload proof (display per channel using LEDs)
- overheating protection (display using LEDs)
- with integrated bus coupling unit
- bus connection via connecting terminal
- with QuickConnect plug-in terminals

<b>Suitable for optional</b>	<b>Order no.</b>
KNX Configuration server easy link RMD	TJA665
KNX system package commissioning tool easy link RMD	TXA100

Design	Order no.	PU
light grey	<b>TXA661B</b>	1

## Universal dimming 2X easy, 2 x 300 W

Powered via bus	21 ... 32 V DC
Auxiliary voltage	230 V AC
Frequency	50/60 Hz
Dimmable LED lamps	per channel 60 W
Dimmable energy-saving lamps	each channel 60 W
Max. number of LED/ESL lamps	max. 8
230 V incandescent lamps and halogen lamps	per channel 300 W
Dimmable conventional transformers	per channel 300 VA
Electronic transformers	per channel 300 W
Operating temperature	- 5 ... + 45 °C
Conductor cross-section (flexible)	0.75 ... 2.5 mm <sup>2</sup>
Conductor cross-section (rigid)	0.75 ... 2.5 mm <sup>2</sup>
Width of rail mounted device (RMD)	4 modules

- Load coupling of 2 channels to increase the output power over parallel connection of the outputs
- Learning function can be activated for optimized operation of compact fluorescent lamps and LED lights via bus
- Manual operation also possible without bus eg. . at construction site
- Manual operation can be activated via switch, thereby disabling the KNX function
- Manual operation per channel via button with integrated status LEDs, thereby blocking the KNX function
- Leading or trailing edge depending on the load type, self learning
- minimum / maximum dimming values set per channel on the device
- Selector switch for manual / bus operation and load adjustment
- short circuit protection and overload protection (electronic fuse)
- short circuit protection and overload protection (via -)
- Overheating protection (via LED)
- Status LED integrated into manual control button
- Overheating protection, indicated by LED
- Overload protection, indicated by LED
- with illuminated Programming button
- with integrated bus coupler
- Bus connection via connecting terminal
- Quick Connect plug-in terminals
- large marking area
- Do not connect conventional transformers together with electronic transformers.



**Suitable for Optional**  
Accessories  
KNX easy commissioning tool

Order no.  
TXA100

Design	Order no.	PU
Univ. dimming actuator 2 channel KNX easy, 2x300W	<b>TXA662AN</b>	1

## Universal dimming 4X easy, 4 x 300 W

Powered via bus	21 ... 32 V DC
Auxiliary voltage	230 V AC
Frequency	50/60 Hz
Dimmable LED lamps	per channel 60 W
Dimmable energy-saving lamps	each channel 60 W
Max. number of LED/ESL lamps	max. 8
230 V incandescent lamps and halogen lamps	per channel 300 W
Dimmable conventional transformers	per channel 300 VA
Electronic transformers	per channel 300 W
Operating temperature	- 5 ... + 45 °C
Conductor cross-section (flexible)	0.75 ... 2.5 mm <sup>2</sup>
Conductor cross-section (rigid)	0.75 ... 2.5 mm <sup>2</sup>
Width of rail mounted device (RMD)	8 modules

- Load coupling of 4 channels to increase the output power over parallel connection of the outputs
- Learning function can be activated for optimized operation of compact fluorescent lamps and LED lights via bus
- Manual operation also possible without bus eg. at construction site
- Manual operation can be activated via switch, thereby disabling the KNX function
- Manual operation per channel via button with integrated status LEDs, thereby blocking the KNX function
- Leading or trailing edge depending on the load type, self learning
- minimum / maximum dimming values set per channel on the device
- Status LED integrated into the manual control button
- Selector switch for manual / bus operation and load adjustment
- short circuit protection and overload protection (electronic fuse)
- short circuit protection and overload protection (via LED)
- Overheating protection (via LED)
- bulb-preserving soft start
- Status LED integrated into manual control button
- Overheating protection, indicated by LED
- Overload protection, indicated by LED
- With illuminated Programming button
- With integrated bus coupler
- Bus connection via connecting terminal
- Quick Connect plug-in terminals
- Large marking area
- Do not connect conventional transformers together with electronic transformers.



**Suitable for Optional**  
Accessories  
KNX easy commissioning tool REG

Order no.  
TXA100

Design	Order no.	PU
Univ. dimming actuator 4 channel KNX easy, 4x300W	<b>TXA664AN</b>	1



**1-10 V Control Unit 3X**

Powered via bus	21 ... 32 V DC	– with red programming LED and red status LED
Switching current	16A	– with manual switch per channel for on / off and status display
Control current for each channel	50 mA	– with programming button
230 V incandescent lamps and halogen lamps per channel	2300 W	– Manual operation also possible without bus eg. B. at construction site
Conventional transformers	1500 VA	– with integrated bus coupler
Electronic transformers	1500 W	– Bus connection via connecting terminal
Florescent lamps with electronic ballasts per channel	1000 W	– suitable for switching various outer conductor
Conductor cross-section (fixed)	1.5 ... 10 mm <sup>2</sup>	– with potential-free NO contacts
Conductor cross-section (flexible)	1 ... 6 mm <sup>2</sup>	– with screw terminals
Operating temperature	0 ... 45°C	
Width of rail mounted device (RMD)	4 modules	

Design	Order no.	PU
Switch / dimming 3X KNX, 1 - 10V	<b>TX211A</b>	1



**DALI actuator 4-fold KNX easy, broadcast**

Powered via bus	21 ... 32 V DC	– Status LED integrated into the manual control button
Auxiliary voltage	230 V AC	– with illuminated Programming button
Frequency	50/60 Hz	– Manual operation also possible without bus eg. at construction site
Operating temperature	- 5 ... 45 ° C	– Manual operation can be activated via switch, thereby disabling the KNX function
Conductor cross-section (flexible)	0.75 ... 2.5 mm <sup>2</sup>	– Manual operation per channel via button with integrated status LEDs, thereby blocking the KNX function
Conductor cross-section (fixed)	0.75 ... 2.5 mm <sup>2</sup>	– Load control via DALI bus in the transmit mode
Width of rail mounted device (RMD)	6 modules	– Automatic load detection
		– With integrated bus coupler
		– Bus connection via connecting terminal
		– Selector switch for manual / bus operation and load adjustment
		– Cable entries beveled
		– Quick Connect plug-in terminals
		– Large marking area
		– Connect an additional DALI power supply

Design	Order no.	PU
DALI actuator 4-fold KNX easy, broadcast RGB (T) W	<b>TXA664D</b>	1

## Universal dim actuator 3gang RMD

Operating voltage over bus	21 ... 32 V=
Auxiliary voltage	230 V~
Frequency	50/60 Hz
Dimmable 230 V LED lamps	per channel 60 W
Quantity of dimmable, 230 V LED lamps	max. 8
Dimmable energy-saving lamps	per channel 60 W
Quantity energy-saving lamps	max. 8
230 V incandescent lamps and halogen lamps	per channel 300 W
Dimmable conventional transformers	per channel 300 VA
Electronic transformers	per channel 300 W
Operating temperature	- 5 ... + 45 °C
Conductor cross-section (flexible)	0.75 ... 2.5 mm <sup>2</sup>
Conductor cross-section (rigid)	0.75 ... 2.5 mm <sup>2</sup>
Dimensions (W x H x D)	105 x 90 x 65 mm
Width of rail mounted device (RMD)	6 modules

Do not connect conventional transformers together with electronic transformers.

- 1, 2 or 3-channel operation possible
- load coupling of 2 or 3 channels settable to increase output power using selection switch
- selection switch for manual/bus operation as well as load setting
- manual operation can be activated via selection switch, thereby deactivation of the KNX function
- manual operation also possible without bus e.g. on building site
- manual operation per channel using button (single-area operation)
- Status LED integrated in manual operation button
- with illuminated programming button
- learning function for optimised operation of compact fluorescent lamps and LED luminaires can be activated via the bus
- specification of the load type per channel possible using button on the device
- phase cut-on or cut-off according to load type, self-learning
- minimum/maximum dimming values per channel settable on device
- Large labelling field
- short-circuit proof and overload proof (display per channel using LEDs)
- overheating protection (display using LEDs)
- with integrated bus coupling unit
- bus connection via connecting terminal
- with QuickConnect plug-in terminals

Suitable for optional	Order no.
KNX Configuration server easy link RMD	TJA665
KNX system package commissioning tool easy link RMD	TXA100



Design	Order no.	PU
light grey	<b>TXA663A</b>	1

## Universal dim actuator 4gang RMD

Operating voltage over bus	21 ... 32 V=
Auxiliary voltage	230 V~
Frequency	50/60 Hz
Dimmable 230 V LED lamps	per channel 60 W
Quantity of dimmable, 230 V LED lamps	max. 8
Dimmable energy-saving lamps	per channel 60 W
Quantity energy-saving lamps	max. 8
230 V incandescent lamps and halogen lamps	per channel 300 W
Dimmable conventional transformers	per channel 300 VA
Electronic transformers	per channel 300 W
Operating temperature	- 5 ... + 45 °C
Conductor cross-section (flexible)	0.75 ... 2.5 mm <sup>2</sup>
Conductor cross-section (rigid)	0.75 ... 2.5 mm <sup>2</sup>
Dimensions (W x H x D)	140 x 90 x 65 mm
Width of rail mounted device (RMD)	8 modules

Do not connect conventional transformers together with electronic transformers.

- selection switch for manual/bus operation as well as load setting
- manual operation can be activated via selection switch, thereby deactivation of the KNX function
- manual operation also possible without bus e.g. on building site
- manual operation per channel using button (single-area operation)
- Status LED integrated in manual operation button
- with illuminated programming button
- learning function for optimised operation of compact fluorescent lamps and LED luminaires can be activated via the bus
- specification of the load type per channel possible using button on the device
- phase cut-on or cut-off according to load type, self-learning
- minimum/maximum dimming values per channel settable on device
- Large labelling field
- suitable to switch different external conductors
- short-circuit proof and overload proof (display per channel using LEDs)
- overheating protection (display using LEDs)
- with integrated bus coupling unit
- bus connection via connecting terminal
- with QuickConnect plug-in terminals

optional	Order no.
KNX Configuration server easy link RMD	TJA665
KNX system package commissioning tool easy link RMD	TXA100



Design	Order no.	PU
light grey	<b>TXA664A</b>	1



**Blind actuators RMD easy**

– The configuration server (order no.: TJA665) or the tool set (order no.: TXA100) is required for easy commissioning via easy link.



**Blind actuator 4gang RMD 24 V DC**

Operating voltage over bus	21 ... 32 V=
Switching current (ohmic)	max. 6 A
Switching current at 24 V=	max. 6 A
Operating temperature	- 5 ... + 45 °C
Conductor cross-section (flexible)	0.75 ... 2.5 mm <sup>2</sup>
Conductor cross-section (rigid)	0.75 ... 2.5 mm <sup>2</sup>
Dimensions (W x H x D)	70 x 90 x 65 mm
Width of rail mounted device (RMD)	4 modules

Follow the motor manufacturers' instructions.

- for activation of a DC drive per actuator channel
- operating mode can be set for roller shutter/awning
- manual operation can be activated via selection switch, thereby deactivation of the KNX function
- manual operation per channel using button (single-area operation)
- Status LED integrated in manual operation button
- with illuminated programming button
- with positioning function for shutter and blade position
- with safety functions e.g. for wind, rain, alarm
- with sun shade function
- Large labelling field
- with integrated bus coupling unit
- bus connection via connecting terminal
- with QuickConnect plug-in terminals

Suitable for optional	Order no.
KNX power supply 2 x 320 mA + 24 V DC, 640 mA RMD	TXA114
KNX Configuration server easy link RMD	TJA665
KNX system package commissioning tool easy link RMD	TXA100
Electrical power supply 24 V DC RMD	TGA200

Design	Order no.	PU
light grey, 4gang	<b>TXA624D</b>	1



**Blind actuator RMD 230 V AC**

Operating voltage over bus	21 ... 32 V=
Frequency	50/60 Hz
Switching current at cos φ = 0.8	max. 6 A
Operating temperature	- 5 ... + 45 °C
Conductor cross-section (flexible)	0.75 ... 2.5 mm <sup>2</sup>
Conductor cross-section (rigid)	0.75 ... 2.5 mm <sup>2</sup>

Follow the motor manufacturers' instructions.

- for activation of an AC drive per actuator channel
- operating mode can be set for roller shutter/awning
- manual operation can be activated via selection switch, thereby deactivation of the KNX function
- manual operation per channel using button (single-area operation)
- Status LED integrated in manual operation button
- with manual operation button for up/down per channel
- with illuminated programming button
- with positioning function for shutter and blade position
- with safety functions e.g. for wind, rain, alarm
- with sun shade function
- Large labelling field
- suitable to switch different external conductors
- with integrated bus coupling unit
- bus connection via connecting terminal
- with QuickConnect plug-in terminals

Suitable for optional	Order no.
KNX system package commissioning tool easy link RMD	TXA10

Design	Order no.	PU
<b>Blind actuator channels for 4 AC drives</b>		
light grey, 4gang <sup>1)</sup>	<b>TXA624C</b>	1
<b>Blind actuator channels for 8 AC drives</b>		
light grey, 8gang <sup>2)</sup>	<b>TXA628C</b>	1



<sup>1)</sup> Dimensions (W x H x D): 70 x 90 x 65 mm, 4 modules  
<sup>2)</sup> Dimensions (W x H x D): 105 x 90 x 65 mm, 6 modules

## Blind actuator 12gang RMD 230 V

Operating voltage over bus	21 ... 32 V=
Frequency	50/60 Hz
Operating temperature	- 5 ... + 45 °C
Conductor cross-section (flexible)	0.5 ... 6 mm <sup>2</sup>
Conductor cross-section (rigid)	0.5 ... 6 mm <sup>2</sup>
Dimensions (W x H x D)	175 x 90 x 65 mm
Width of rail mounted device (RMD)	10 modules

Follow the motor manufacturers' instructions.

- for activation of an AC drive per actuator channel
- operating mode can be set for roller shutter/awning
- selection switch for manual/bus operation and second operating level
- manual operation can be activated via selection switch, thereby deactivation of the KNX function
- Manual operation per channel using button (single-area operation, two operating levels)
- Status LED integrated in manual operation button
- with manual operation button for up/down per channel
- with illuminated programming button
- with positioning function for shutter and blade position
- with safety functions e.g. for wind, rain, alarm
- with sun shade function
- with integrated bus coupling unit
- Large labelling field
- suitable to switch different external conductors
- bus connection via connecting terminal
- with screw terminals



<b>Suitable for optional</b>	<b>Order no.</b>
KNX Configuration server easy link RMD	TJA665
KNX system package commissioning tool easy link RMD	TXA100

Design	Order no.	PU
light grey	<b>TXM632C</b>	1

## HVAC actuators RMD

- The configuration server (order no.: TJA665) or the tool set (order no.: TXA100) is required for easy commissioning via easy link.

## Heating actuator 6 channel with controller, 24/230 V, Triac

Operating voltage over bus	21 ... 32 V DC
Frequency	50/60 Hz
Switching voltage	24 ... 230 V
Power consumption (operating)	1 W
Actuators 24 V	per chnl. max 2
Actuators for each channel	max. 4
Operating temperature	- 5 ... 45 °C
Conductor cross-section (flexible)	0.5 ... 4 mm <sup>2</sup>
Conductor cross-section (fixed)	0.5 ... 4 mm <sup>2</sup>
Width of rail mounted device (RMD)	4 modules

- 12 with integrated room temperature controllers
- Type of actuator (normally closed / open) adjustable
- for actuator 230 V or actuator 24 V
- with valve protection function
- Locking function per actuator output via manual operation buttons or bus activatable
- different setpoints set to forced control or emergency operation in case of bus failure for summer and winter time
- 6 manual operation buttons for on/off each actuator channel
- short circuit protection and overload protection (via LED)
- 6 red status LEDs for indicating the input status
- with programming button and red programming LED
- with integrated bus coupler
- Bus connection via connecting terminal
- with screw
- All actuator channels must be of the same operating voltage



Design	Order no.	PU
Heating actuator KNX 6 channel, with Controller, 24 / 230V	<b>TXM646R</b>	1



**Heating actuator 6 gang easy, 24/230 V, triac**

Powered via bus	21 ... 32 V DC	<ul style="list-style-type: none"> <li>- type of actuator (normally closed/open) adjustable</li> <li>- for actuator 230 V or actuator 24 V</li> <li>- with valve protection function</li> <li>- locking function per actuator output via manual operation buttons or bus activatable</li> <li>- different setpoints set to forced control or emergency operation in case of bus failure for summer and winter time</li> <li>- 6 manual operation buttons for on/off each actuator channel</li> <li>- short circuit protection and overload protection (via LED)</li> <li>- 6 red status LEDs for indicating the input status</li> <li>- with programming button and red programming LED</li> <li>- with integrated bus coupler</li> <li>- Bus connection via connecting terminal</li> <li>- with screw terminals</li> <li>- At all actuator channels actuators of the same operating voltage must be connected</li> </ul>
Frequency	50/60 Hz	
Switching voltage	24 ... 230 V	
Power consumption (operating)	1 W	
Actuators 24 V	per chnl. max 2	
Actuators for each channel	max. 4	
Operating temperature	-5 ... 4 mm <sup>2</sup>	
Conductor cross-section (flexible)	0.5 ... 4 mm <sup>2</sup>	
Conductor cross-section (fixed)	0.5 ... 4 mm <sup>2</sup>	
Width of rail mounted device (RMD)	4 modules	

Design	Order no.	PU
Heating actuator 6 gang easy, 24/230 V	<b>TXM646T</b>	1



**Surface mounted housing for heating actuator**

Mounting	surface	<ul style="list-style-type: none"> <li>- surface mounted housing for heating actuator in heating circuit, IP31</li> </ul>
Protection	IP31	
Height	157mm	
Width	104MM	
Depth	89mm	
Colour	White	
Material	plastic	
Operating temperature	-5 ... 45°C	

Design	Order no.	PU
Housing for heating actuator, IP31	<b>TGC600</b>	1



**KNX actuator**

Powered via bus	21 ... 32 V DC	<ul style="list-style-type: none"> <li>- matching the standard thermostatic valve bodies</li> <li>- with programming button and red programming LED</li> <li>- with valve protection function</li> <li>- features summer mode and forced mode</li> <li>- for continuous PI control</li> <li>- with 5 LEDs to indicate the valve lift</li> <li>- with 2 independent binary inputs</li> <li>- with integrated bus coupler</li> <li>- Bus connection via connecting terminal</li> </ul>
Operating temperature	+ 0 ... + 50 °C	
Pre-assembled cables	= 1 m	
Dimensions (L x W x H)	65 x 50 x 82 mm	
<p>- Enclosed are two valve adapters, suitable for: Danfoss RAH, eimeier, MNG, Schlösser from 03/93, Honeywell, Braukmann, Dumser (distributor), Reich (distributor), Landis + Gyr, Oventrop, Herb, Onda</p>		

Design	Order no.	PU
Actuator motor, KNX	<b>TX501</b>	1



**KNX actuator with temperature controller**

Powered via bus	21 ... 32 V DC	<ul style="list-style-type: none"> <li>- matching the standard thermostatic valve bodies</li> <li>- Operating modes: comfort, standby, night economy, frost / heat protection</li> <li>- with programming button and red programming LED</li> <li>- with valve protection function</li> <li>- Features summer mode and forced mode</li> <li>- for continuous PI control</li> <li>- with 5 LED's to indicate the valve lift</li> <li>- with 2 independent binary inputs</li> <li>- with integrated bus coupler</li> <li>- Bus connection via connecting terminal</li> <li>- for heating or cooling mode</li> <li>- assembled, with tap</li> <li>- Enclosed are two valve adapters, suitable for: Danfoss RAH, eimeier, MNG, Schlösser from 03/93, Honeywell, Braukmann, Dumser (distributor), Reich (distributor), Landis + Gyr, Oventrop, Herb, Onda</li> </ul>
Operating temperature	+ 0 ... + 50 °C	
Pre-assembled cables	= 1 m	
Dimensions (L x W x H)	65 x 50 x 82 mm	

Design	Order no.	PU
Actuator with temperature control, KNX	<b>TX502</b>	1



**Actuator 230 V**

Operating voltage	230 V AC	– normally closed
Frequency	50/60Hz	– with dismantling protection
Operating temperature	0 ... 50° C	– pluggable connection cable
Pre-assembled cable	= 1m	– for plug-in mounting
Dimensions (W x H x D)	42 x 50 x 64mm	– with over-temperature protection
Cable length	max. 200m	– (Open or closed) with status indicator
Running time	42 s / mm	– Thermoelectric operation
Stroke	5mm	– Valve adapter included.
		– Bus connection via connecting terminal



mandatory accessory                                      Order no.  
Valve adapter kit for actuator                            EK072

Design	Order no.	PU
Actuator 230V, M30x1.5	<b>EK723</b>	1

**Actuator 24 V AC/DC**

Operating voltage	24 V AC/DC	– normally closed
Operating temperature	0 ... 50° C	– with dismantling protection
Pre-assembled cable	= 1m	– pluggable connection cable
Dimensions (W x H x D)	42 x 50 x 64 mm	– for plug-in mounting
Cable length	max. 200 m	– with over-temperature protection
Running time	54 s / mm	– (open or closed) with status indicator
Stroke	5 mm	– Thermoelectric operation
		– Valve adapter included.



mandatory accessory                                      Order no.  
Valve adapter kit for actuator                            EK072

Design	Order no.	PU
Actuator 24 V AC/DC, M30 x 1.5	<b>EK724</b>	1

**Valve adaptor for actuator**

– for actuator 230 V, actuator 24 V, KNX actuator or actuator radio



Design	Order no.	PU
Valve adapter kit for actuator	<b>EK072</b>	1



**KNX valve drive with thermostat**

Operating voltage over bus	21 ... 32 V=	– suitable for standard heater valve tappets
Operating temperature	+ 0 ... + 50 °C	– with programming button and red programming LED
Pre-assembled cables	≈ 1 m	– summer operation
Dimensions (L x W x H)	65 x 50 x 82 mm	– with 2 independent binary inputs
		– with 5 LEDs for display of valve stroke
		– with integrated bus coupling unit
		– bus connection via connecting terminal
		– for heating or cooling mode
		– operating modes: comfort, standby, night lowering, frost/heat protected
		– pre-assembled, with cables

Design	Order no.	PU
white	<b>TX502</b>	1

**Flush-mounted actuators easy**

– The configuration server (order no.: TJA665) or the tool set (order no.: TXA100) is required for easy commissioning via easy link.



**Switch actuator 1gang flush-mounted 10 A**

Operating voltage over bus	21 ... 32 V=	– status LED integrated into the manual operation button
max. switching capacity at	230 V~	– with illuminated programming button/button for manual operation
Frequency	50/60 Hz	– with integrated bus coupling unit
Switching current at cos φ = 0.8	max. 10 A	– with potential-free normally-open contact
Current consumption KNX {typ.}	typ. 7 mA	– pre-assembled, with cables
230 V LED lamps	5 x 15 W	– installation in flush-mounted or splash-protected junction box
Energy-saving lamps	5 x 15 W	– Bus connection via pre-assembled cable with bus connection terminal
230 V incandescent lamps	600 W	– with screw terminals
230 V halogen lamps	600 W	
Conventional transformers	600 VA	
Electronic transformers	600 W	
Fluorescent lamps:		
– with electronical ballast (EB)	6 x 58 W	
Compact fluorescent lamps	600 W	
Operating temperature	- 5 ... + 45 °C	
Conductor cross-section (flexible)	0.75 ... 2.5 mm <sup>2</sup>	
Conductor cross-section (rigid)	0.75 ... 2.5 mm <sup>2</sup>	
Dimensions (W x H x D)	44 x 22.5 x 43 mm	

<b>Suitable for optional</b>	<b>Order no.</b>
KNX Configuration server easy link RMD	TJA665
KNX system package commissioning tool easy link RMD	TXA100

Design	Order no.	PU
light grey, 1gang	<b>TXB601B</b>	1



**Switch actuator/blind actuator 2/1gang + binary input 2gang flush-mounted 6 A**

Operating voltage over bus	21 ... 32 V=	– for switching of two independent loads or activation of a blind drive per
max. switching capacity at	230 V~	– with positioning function for shutter and blade position
Frequency	50/60 Hz	– status LED integrated into the manual operation button
230 V LED lamps	5 x 13 W	– with illuminated programming button
Energy-saving lamps	5 x 13 W	– with potential-free normally-open contact
230 V incandescent lamps	500 W	– pre-assembled, with cables
230 V halogen lamps	500 W	– installation in flush-mounted or splash-protected junction box
Conventional transformers	500 VA	– bus connection via KNX bus connection cable
Electronic transformers	500 W	– with screw terminals
Fluorescent lamps:		
– uncompensated	500 VA	
– with electronical ballast (EB)	6 x 48 W	
Operating temperature	- 5 ... + 45 °C	
Conductor cross-section (flexible)	0.75 ... 2.5 mm <sup>2</sup>	
Conductor cross-section (rigid)	0.75 ... 2.5 mm <sup>2</sup>	

<b>Suitable for optional</b>	<b>Order no.</b>
KNX Configuration server easy link RMD	TJA665
KNX system package commissioning tool easy link RMD	TXA100

Follow the motor manufacturers' instructions.

Design	Order no.	PU
light grey	<b>TXB602F</b>	1

**Switch actuator/blind actuator 2/1gang+ binary input  
2gang flush-mounted 6 A**

Operating voltage over bus	21 ... 32 V=
max. switching capacity at	230 V~
Frequency	50/60 Hz
230 V LED lamps	5 x 13 W
Energy-saving lamps	5 x 13 W
230 V incandescent lamps	500 W
230 V halogen lamps	500 W
Conventional transformers	500 VA
Electronic transformers	500 W
Fluorescent lamps:	
- uncompensated	500 VA
- with electronical ballast (EB)	6 x 48 W
Operating temperature	- 5 ... + 45 °C
Binary cable length, extendable to	max. 9.9 m
Conductor cross-section (flexible)	0.75 ... 2.5 mm <sup>2</sup>
Conductor cross-section (rigid)	0.75 ... 2.5 mm <sup>2</sup>

- 2 binary inputs and 2 switching outputs or 1 blind input parameterisable
- any combined operation from binary input and drive or switching functions possible
- binary input functions: Switching, dimming, blind, scene, forced control and timer operation
- with positioning function for shutter and blade position
- status LED integrated into the manual operation button
- with illuminated programming button
- with potential-free normally-open contact
- pre-assembled, with cables
- installation in flush-mounted or splash-protected junction box
- Bus connection via pre-assembled cable with bus connection terminal
- with screw terminals



Follow the motor manufacturers' instructions.

Suitable for optional	Order no.
KNX system package commissioning tool easy link RMD	TXA100

Design	Order no.	PU
light grey	<b>TXB692F</b>	1

**KNX System devices**

**System tools easy**

**KNX Configuration server easy link RMD**

Operating voltage over bus	21 ... 32 V=
Auxiliary voltage	24 V=
Transmission rate Ethernet	max. 2 x 100/1000 Mbit/s
Operating temperature	+ 0 ... + 45 °C
Conductor cross-section (flexible)	0.75 ... 2.5 mm <sup>2</sup>
Conductor cross-section (rigid)	0.75 ... 2.5 mm <sup>2</sup>
Width of rail mounted device (RMD)	6 modules

- Configuration tool for commissioning of KNX installations in easy mode
- Selection switch for online/offline mode
- with green and red status LED for LAN status, operational stand-by, KNX status and gateway connection
- with illuminated programming button
- Power supply via PoE
- 2 RJ45 Ports for LAN connection
- with 2 USB jacks type B, USB 2.0 compliant
- Large labelling field
- with integrated bus coupling unit
- bus connection via connecting terminal
- with QuickConnect plug-in terminals



Knowledge of the relevant network technology is required for installation. System requirements: Windows 8.1, Android 4.4, iOS 8.

Suitable for	Order no.
KNX Operating systems	
KNX Sensors	
KNX Actuators	
KNX power supply 2 x 320 mA + 24 V DC, 640 mA RMD	TXA114

Design	Order no.	PU
light grey	<b>TJA665</b>	1



**KNX system package commissioning tool easy link RMD**

Transmission rate Ethernet max. 2 x 100/1000 Mbit/s

Set consisting of:

- Configuration server RMD, order no. TJA665
- Power supply 30 V DC + 24 V DC RMD, order no. TXA114
- WIFI access-point
- KNX bus connection
- RJ45 connection cable

Knowledge of the relevant network technology is required for installation. System requirements: Windows 8.1, Android 4.4, iOS 8.

The system package has been designed as a complete set for commissioning via easy link.

- Portable suitcase with a complete set of devices needed for commissioning of KNX installations in easy mode
- for connection to a 230 V AC socket outlet
- with two RJ45 jacks
- Selection switch for online/offline mode
- with green and red status LED for LAN status, operational stand-by, KNX status and gateway connection
- RJ45 Port for LAN connection
- with 2 USB jacks type B, USB 2.0 compliant

Suitable for	Order no.
KNX Operating systems	
KNX Sensors	
KNX Actuators	
replacement	
KNX power supply 2 x 320 mA + 24 V DC, 640 mA RMD	TXA114

Design	Order no.	PU
KNX system package commissioning tool easy link RMD	<b>TXA100</b>	1

**Power supplies**



**KNX power supply 640 mA RMD**

Operating voltage	230 V~
Frequency	50/60 Hz
Output voltage	28 ... 32 V=
Output current	max. 640 mA
Bus lines	max. 1
Operating temperature	- 5 ... + 45 °C
Conductor cross-section (flexible)	0.75 ... 2.5 mm <sup>2</sup>
Conductor cross-section (rigid)	0.75 ... 2.5 mm <sup>2</sup>
Width of rail mounted device (RMD)	4 modules

- one output 640 mA incl. choke
- with electronic short-circuit and overload protection
- protected earth conductor must be connected
- with QuickConnect plug-in terminals

Design	Order no.	PU
light grey	<b>TXA112</b>	1



**KNX power supply 2 x 320 mA RMD**

Operating voltage	230 V~
Frequency	50/60 Hz
Output voltage	28 ... 32 V=
Output current	max. 640 mA
Bus lines	max. 2
Operating temperature	- 5 ... + 45 °C
Conductor cross-section (flexible)	0.75 ... 2.5 mm <sup>2</sup>
Conductor cross-section (rigid)	0.75 ... 2.5 mm <sup>2</sup>
Width of rail mounted device (RMD)	4 modules

- with green LED for display of power supply per output
- with red LED for display of short-circuit and overload protection per output
- with 2 outputs incl. choke per output
- with electronic short-circuit and overload protection
- protected earth conductor must be connected
- with QuickConnect plug-in terminals

Design	Order no.	PU
light grey	<b>TXA116</b>	1



**KNX power supply 320 mA RMD**

Operating voltage	230 V~
Frequency	50/60 Hz
Output voltage	28 ... 32 V=
Output current	max. 320 mA
Bus lines	max. 1
Operating temperature	- 5 ... + 45 °C
Conductor cross-section (flexible)	0.75 ... 2.5 mm <sup>2</sup>
Conductor cross-section (rigid)	0.75 ... 2.5 mm <sup>2</sup>
Width of rail mounted device (RMD)	4 modules

- one output 30 V DC, 320 mA incl. choke
- with electronic short-circuit and overload protection
- protected earth conductor must be connected
- with QuickConnect plug-in terminals

Design	Order no.	PU
light grey	<b>TXA111</b>	1

**KNX power supply 2 x 320 mA + 24 V DC, 640 mA RMD**

Operating voltage	230 V~	– with green LED for display of power supply per output
Frequency	50/60 Hz	– with red LED for display of short-circuit and overload protection per output
Output voltage	28 ... 32 V=	– one output 30 V DC, 320 mA incl. choke
Output current	max. 320 mA	– one output 24 V, 640 mA
Bus lines	max. 1	– with electronic short-circuit and overload protection
Operating temperature	- 5 ... + 45 °C	– protected earth conductor must be connected
Conductor cross-section (flexible)	0.75 ... 2.5 mm <sup>2</sup>	– with QuickConnect plug-in terminals
Conductor cross-section (rigid)	0.75 ... 2.5 mm <sup>2</sup>	
Width of rail mounted device (RMD)	4 modules	



<b>Suitable for</b>	<b>Order no.</b>
Blind actuator 4gang RMD 24 V DC	T XA624D
Weather station with GPS surface-mounted	TXE531
KNX thermostat	8044 01 00
KNX room controller	8066 01 00
KNX Configuration server easy link RMD	TJA665
KNX system package commissioning tool easy link RMD	TXA100

Design	Order no.	PU
light grey	<b>TXA114</b>	1

**Electrical power supply 24 V DC RMD**

Operating voltage	230 V~	– with QuickConnect plug-in terminals
Frequency	50/60 Hz	
Output voltage	24 V=	
Output current	max. 1 A	
Current consumption	< 150 mA	
Power consumption	36 W	
Operating temperature	+ 0 ... + 45 °C	
Width of rail mounted device (RMD)	4 modules	



<b>Suitable for</b>	<b>Order no.</b>
Touch Panel	
Weather station with GPS surface-mounted	TXE531
Blind actuator 4gang RMD 24 V DC	T XA624D
domovea Server incl. software RMD	TJA450
KNX room controller	8066 01 00
KNX thermostat	8044 01 00

Design	Order no.	PU
light grey matt	<b>TGA200</b>	1

**Bus cable**

EIB-Y (ST) Y x 2 x 2 x 0.8mm		
Insulated 4kV, possible installation		
Near LV conductors	length 100m	<b>TG018</b>
	length 500m	<b>TG019</b>



<b>Bus connector</b>	<b>TG008</b>
(package = 50 pieces)	
4 links per connector	



**Couplers**

**Coupler RMD**

Operating voltage over bus	21 ... 32 V=	– with 2 yellow data traffic LEDs for higher and lower ranking line
Operating temperature	- 5 ... + 45 °C	– with green operation LED, red programming LED and red diagnosis LED
Dimensions (W x H x D)	36 x 90 x 70 mm	– with programming button
Width of rail mounted device (RMD)	2 modules	– line connection via connecting terminal



Design	Order no.	PU
light grey	<b>TYF130</b>	1



**Characteristics**

- Transmitters are uni-directional in use and bi-directional during configuration
- Frequency: 868.3 MHz radio KNX
- Low battery indication
- Average life of battery: 5 years
- Range: 100m in open field





**Radio wall detectors**



Can be fixed in a location and used to control a radio receiver with a 230V 10A contact.

**Characteristics**

- Available in battery and solar versions
- Detection angle: 220°

- IP55/IK04
- Uni-directional in use and bi-directional during configuration
- Frequency: 868.3 MHz KNX radio
- Range: 100m in free field
- Delivered with 3 x 1.5V batteries.

	Description	Characteristics		Cat. ref.
 <p>TRE520</p>	<b>IR movement detectors wall mounted KNX radio</b>	battery emitter solar emitter	white	TRE520
			anthracite	TRE521
			white	TRE530
			anthracite	TRE531
 <p>TRE600</p>	<b>IR movement detector and LED floodlight</b>		white	TRE600
 <p>TRE302</p>	<b>Pushbuttons IP55 KNX radio</b>	1 button/1 input		TRE301
		2 buttons/2 inputs		TRE302
 <p>TRB302B</p>	<b>Recessed input modules KNX radio</b>	2 input battery supply CR1/2 AA 3V for 2 volt-free input contacts		TRM702A TRB302B
		2 input 230V supply for 2 volt-free input contacts		

	Description	Characteristics		Cat. ref.
 <p>TU404</p>  <p>TU418</p>	<b>KNX radio remote controls</b>  Delivered with battery CR2430-3V	2 button		TU402
		4 button		TU404
		6 button		TU406
		6 button 18 channels		TU418

KNX radio receivers act as power interfaces to control electrical loads.



### Characteristics

- Bi-directional receivers
- Frequency: 868.3 MHz KNX radio

### Lighting functions

- ON/OFF (impulse)
- ON
- OFF
- ON/OFF (switch)
- Timer
- Force ON
- Force OFF

### Shutter functions

- Up
- Down
- Scenario
- Up/down (switch)
- Force up
- Force down

Description	Characteristics	Cat. ref.	
Recessed receiver ON/OFF KNX radio	2 binary inputs + 1 x 2-wire output 200W	TRM690G	<p>TRM693G</p>
Combined input/output unit KNX radio	2 binary inputs + 1 output 3A, 230V	TRM693G	
	2 binary inputs + 1 potential-free output 4A	TRM694G	
Recessed shutter/blind receiver KNX radio	2 binary inputs + 1 shutter output 3A, 230V	TRM692G	<p>TRM692G</p>
Combined input/output unit KNX radio			
Recessed dimmer KNX radio	2 binary inputs + 1 2-wire dimmer output 200W	TRM691E	<p>TRM691E</p>
Receiver ON/OFF IP55 KNX radio	dimensions 150 x 85 x 35mm	TRE201	<p>TRE202</p>
	1 output 10A/230V AC1	TRE202	
	2 outputs 10A/230V AC1		
Receiver shutter/blind IP55 KNX radio	dimensions 150 x 85 x 35mm  1 output shutter/blind up/down 4 wire (t, l, Ph, N) 10A/230V AC1	TRE221	<p>TRE202</p>
Receiver 1 input + 1 output IP55 KNX radio	1 volt-free input contact 1 output 10A/230V AC1	TRE400	
Motion detector kit IP55 KNX radio	includes: 1 TRE520 motion detector 1 TRE201 wall mounted output	TRE720	



## Media coupler

Serves as link between the wire and radio product

## Repeater

Amplifies the KNX radio signal. Utilisation: if distance is important or unfavourable environment.



TR131B



TR140B



9061-00



98550910



TG200C

Description	Characteristics	Cat. ref.
<b>Media coupler</b> Allows transmission of messages of twisted pair products towards radio products and vice versa	supply: via bus frequency: 868,3 MHz bidirectional product	TR131B
<b>A radio repeater</b> To be used in case of poor communication, amplifies the radio messages	supply: 230 V frequency: 868,3 MHz bidirectional product dim. : 111 x 51 x 18 mm	TR140B
<b>Cavity wall 1 gang box</b> with device screws	Depth: 35mm Cut-out dimension: Ø = 68mm	9061-00
<b>Adapter support ring</b> steel		98550910
<b>Bag of 50 bridges</b>	black gray brown	TG200A TG200B TG200C





# Numerical Index

Cat ref.	Page Number	Cat ref.	Page Number	Cat ref.	Page Number	Cat ref.	Page Number
<b>#</b>							
98550910	88	8096 01 85	55	TU402	86	WFGP1BS	53
1011 30 01	39	8096 01 89	55	TU404	86	WFGP1PS	52
1011 30 04	38	8096 02 82	34	TU406	86	WFGP2BN	53
1011 30 05	38	8096 02 83	34	TU418	86	WFGP2BS	53
1011 30 12	39	8096 02 85	34	TX211A	76	WFGP2PS	52
1011 30 16	39	8096 02 89	34	TX501	80	WFGP3BN	53
1011 30 21	38	8096 02 99	34	TX502	80	WFGP3BS	53
1011 30 22	39	8096 03 82	35	TX502	82	WFGP3PS	52
1011 30 25	38	8096 03 83	35	TXA022	67	WFGP4BN	53
1011 30 46	39	8096 03 85	35	TXA025	64	WFGP4BS	53
1011 36 06	43	8096 03 89	35	TXA026	65	WFGP4PS	52
1011 36 09	43	8096 03 99	35	TXA100	84	WFGP6BN	53
1011 39 04	38	8096 04 52	62	TXA111	84	WFGP6BS	53
1011 64 14	44	8096 04 59	62	TXA112	84	WFGP6PS	52
1011 64 24	42	8096 04 83	62	TXA114	85	WFGP8BN	53
1011 66 16	43	8096 04 85	62	TXA116	84	WFGP8BS	53
1011 66 26	42	9061-00	88	TXA304	70	WFGP8PS	52
1011 69 04	42			TXA306	70	WMGF1	53
1011 69 09	43	<b>E</b>		TXA310	70	WMGF2	53
1011 69 14	42	EE002	65	TXA604D	72	WMGF34	53
1011 69 19	42	EE003	65	TXA606B	71	WMGP1	52
1011 89 62	36	EE807	64	TXA606D	72	WMGP2	52
1011 89 82	36	EE808	64	TXA608B	71	WMGP3	52
1011 89 89	36	EE813	63	TXA608D	72	WMGP4	52
1011 99 39	36	EEK005	64	TXA610B	71	WMGP6	52
1011 99 49	36	EG003G	68	TXA610D	72	WMGP8	52
1309 30 01	41	EG004	67	TXA624C	78	WMGS13R	52
1309 30 04	40	EG005	68	TXA624D	78	WMGS13RB	52
1309 30 05	40	EK072	81	TXA628C	78	WMGS13RR	52
1309 30 12	41	EK090	66	TXA661A	74	WMGS22R	52
1309 30 16	41	EK723	81	TXA661B	74	WRGP12BN	53
1309 30 21	40	EK724	81	TXA662AN	75	WRGP12BS	53
1309 30 22	41			TXA663A	77	WRGP12PS	52
1309 30 25	40	<b>T</b>		TXA664A	77	WRGP1BN	53
1309 30 46	41	TCC510S	63	TXA664AN	75	WRGP1BS	53
1309 36 06	45	TG008	85	TXA664D	76	WRGP1PS	52
1309 36 06	45	TG018	85	TXB302	68	WRGP2BN	53
1309 36 09	45	TG019	85	TXB304	69	WRGP2BS	53
1309 39 04	40	TG200A	88	TXB322	69	WRGP2PS	52
1309 64 14	45	TG200B	88	TXB344	69	WRGP3BN	53
1309 64 24	44	TG200C	88	TXB601B	82	WRGP3BS	53
1309 66 16	45	TGA200	85	TXB602F	82	WRGP3PS	52
1309 66 26	44	TGC600	80	TXB692F	83	WRGP4BN	53
1309 69 04	45	TGM600E	73	TXC511	63	WRGP4BS	53
1309 69 14	44	TGM620D	73	TXE531	66	WRGP4PS	52
1309 69 19	44	TJA450	60	TXM616D	73	WRGP6BN	53
1309 89 82	37	TJA451	61	TXM616D	73	WRGP6BS	53
1309 89 89	37	TJA470	61	TXM620D	73	WRGP6PS	52
1309 99 09	37	TJA665	83	TXM632C	79	WRGP8BN	53
1309 99 39	37	TJA670	61	TXM646R	79	WRGP8BS	53
1309 99 49	37	TR131B	88	TXM646T	80	WRGP8PS	52
8004 00 01	30	TR140B	88	TYF130	85	WS401	50
8004 00 11	30	TRB302B	86			WS401N	50
8014 11 80	34	TRE201	87	<b>W</b>		WS401T	50
8016 17 80	30	TRE202	87	WDI070	56	WS450Y	51
8016 17 85	30	TRE221	87	WDI100	57	WST302	46
8016 27 80	31	TRE301	86	WDI101	58	WST302N	48
8016 27 85	31	TRE302	86	WDI161	59	WST302T	48
8016 37 80	32	TRE400	87	WDW070	59	WST304	48
8016 37 85	32	TRE520	86	WDW071	60	WST304N	48
8016 47 80	33	TRE521	86	WDW100	59	WST304T	48
8016 47 85	33	TRE530	86	WDW101	60	WST306	48
8026 21 80	61	TRE531	86	WDW160	59	WST306N	48
8026 22 80	62	TRE600	86	WDW161	60	WST306T	48
8044 01 00	54	TRE720	87	WFGF1	53	WST312	48
8066 01 00	55	TRM690G	87	WFGF2	53	WST312N	48
8096 01 80	55	TRM691E	87	WFGF34	53	WST312T	48
8096 01 82	55	TRM692G	87	WFGP12BN	53	WST314N	48
8096 01 83	55	TRM693G	87	WFGP12BS	53	WST314T	48
		TRM694G	87	WFGP12PS	52	WST316	48
		TRM702A	86	WFGP1BN	53		

# Numerical Index

<b>Cat ref.</b>	<b>Page Number</b>	<b>Cat ref.</b>	<b>Page Number</b>	<b>Cat ref.</b>	<b>Page Number</b>	<b>Cat ref.</b>	<b>Page Number</b>
WST316N	48						
WST316T	48						
WST322	49						
WST322N	49						
WST322T	49						
WST324	49						
WST324N	49						
WST324T	49						



**Hager Ltd. - Ireland**

Unit M2  
Furry Park Industrial Estate  
Swords Road  
Santry  
Dublin 9  
D09 NY19  
Ireland

Republic of Ireland Tel: 1890 551 502  
Republic of Ireland Fax: 1890 551 503  
Northern Ireland Tel: 00 44 2890 020165  
Northern Ireland Fax: 00 353 1 8869520

[hager.ie](http://hager.ie)  
[customer.service@hager.ie](mailto:customer.service@hager.ie)

**Hager Ltd.**

Hortonwood 50  
Telford  
Shropshire  
TF1 7FT

Sales Service Centre: 01952 675612  
Sales Service Centre Faxline: 01952 675645  
Technical Service Centre: 01952 675689  
Technical Service Centre Faxline: 01952 675557

[hager.co.uk](http://hager.co.uk)  
[sales@hager.co.uk](mailto:sales@hager.co.uk)  
[technical@hager.co.uk](mailto:technical@hager.co.uk)